

W.R. 649

MELVIN & MARGARET STENBERG

SEC. 29, T. 12 S., R. 1 W., W.M., LINN CO., ORE.

Scale: 1" = 10 Chains

Sept. 1, 1958

ORRIS A. CARNEGIE
DEP. CO. SURVEYOR

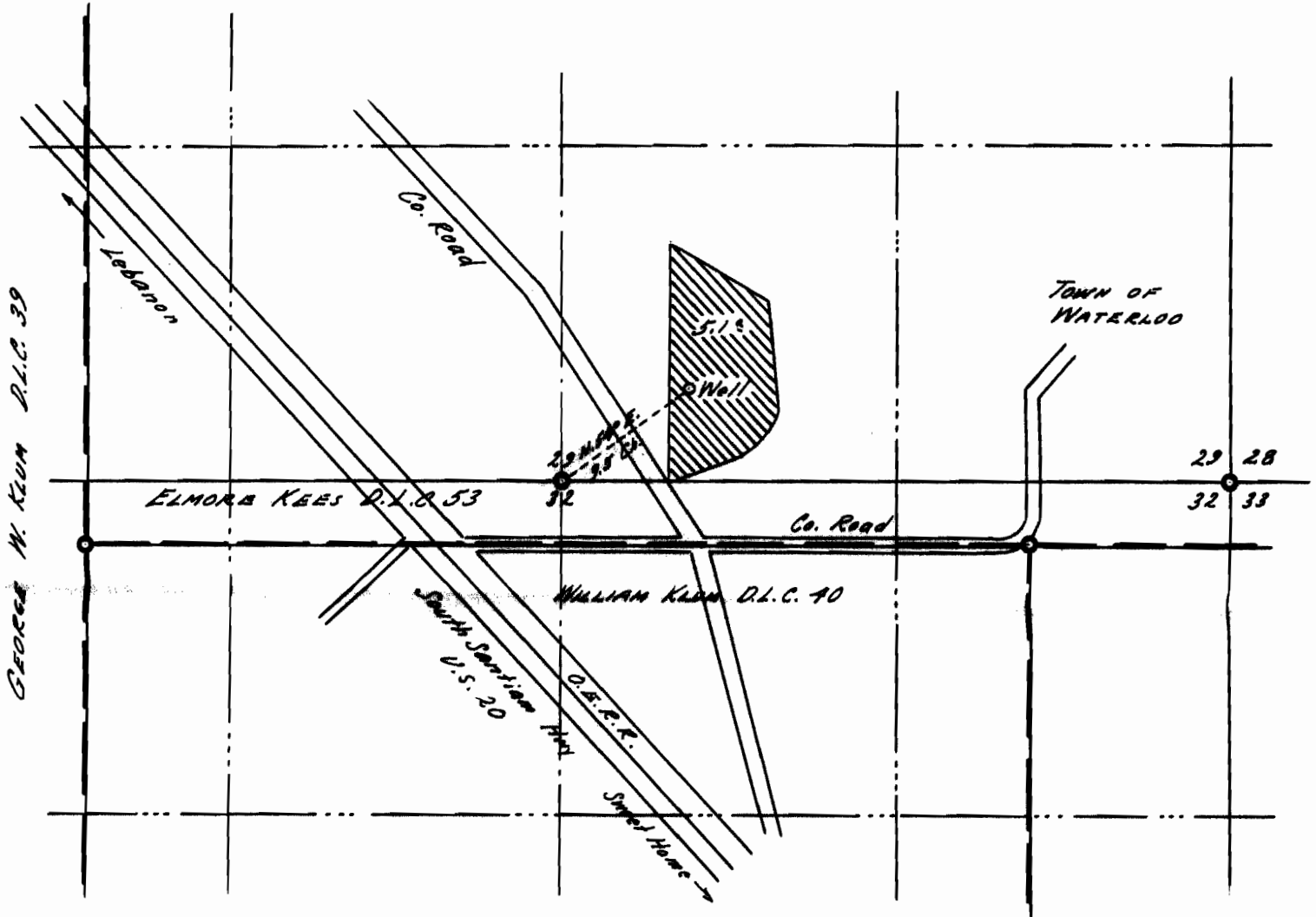

GEORGE W. KUM D.L.C. 39

Elev. of Well approx. 410 Ft. above M.S.L.
(from U.S. G.S. map)

This map drawn from County Records &
air photos.

REGISTERED
OREGON
LAND SURVEYOR

Orris A. Carnegie

MAY 9, 1947
ORRIS A. CARNEGIE
213

Application No. G-1243

Permit No. G-1075