

T.75. R.2 W.W.M.

3

RECEIVED

FEB 02 1990

WATER RESOURCES DEPT.  
SALEM, OREGON

INDIGO ST.

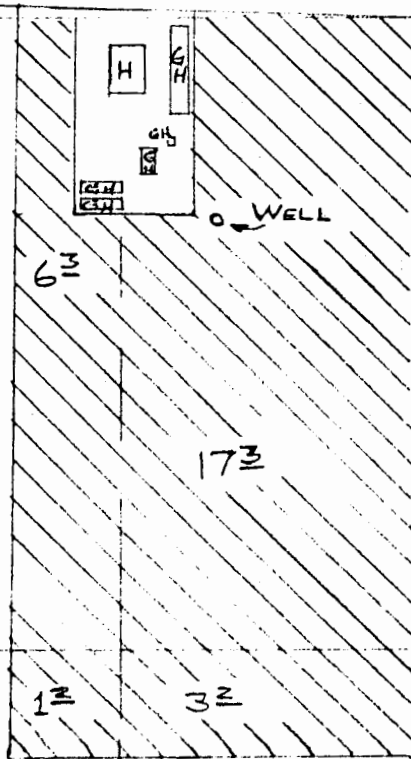

Application No. G-12027  
Permit No. G10984

3 2  
10 11  
WELL LOCATION  
900' NORTH  
AND 1120' WEST  
OF SE CORNER  
SECTION 3

### APPLICATION MAP

APPLICATION \_\_\_\_\_

GLEN HANSBERRY

JAN 20, 1990 BY:

SCALE: 1 IN: 400 FT

NOTE: MAP IS FOR  
PURPOSE OF IDENTIFYING  
LOCATION OF WATER RIGHT  
AND HAS NO INTENT TO  
DIMENSION OR LOCATE  
PROPERTY OWNERSHIP  
LINES.

