

T 3 S , R 38 E , WM

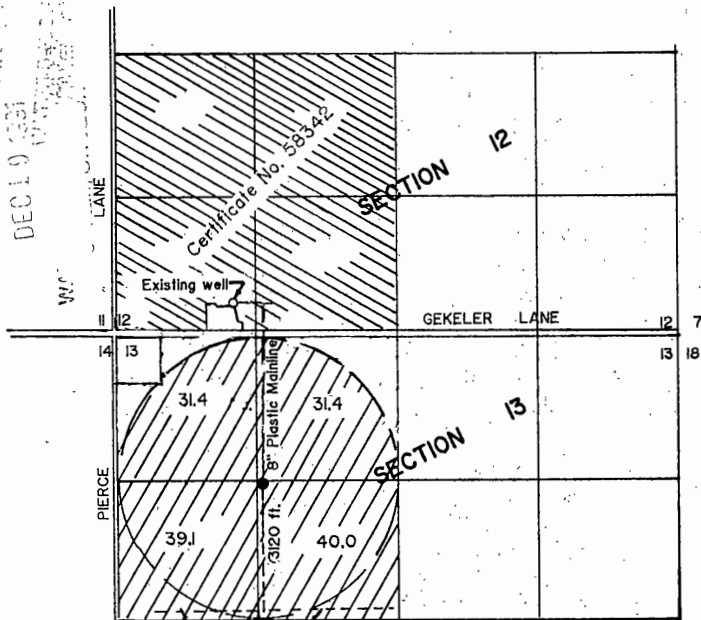

4" Steel portable handline.

5" Plastic buried line for handline, 1320 Ft.

POINT OF DIVERSION : 260 Ft. North and 100 Ft. East from the Southwest Corner of Section 12. (Existing well)

NOTE:

The preparation of this map is for the purpose of identifying the location of the water right only and has no intent to provide dimensions or location of property ownership lines

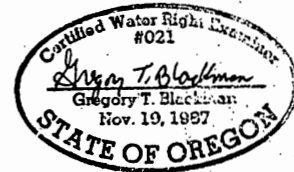

APPLICATION NO

6-12028

PERMIT NO

G11021



BAGETT - GRIFFITH & ASSOCIATES

LaGrande, Oregon

PERMIT APPLICATION MAP

SEE ATTACHED LEGAL DESCRIPTION

UNION COUNTY, OREGON

SURVEYED FOR	Paul C. Rudd	
SURVEYED BY	GTB	
Scale: 4" = 1 MILE	Drawn by: GTB	1-31-90