

T.2S., R.4E., W.M.

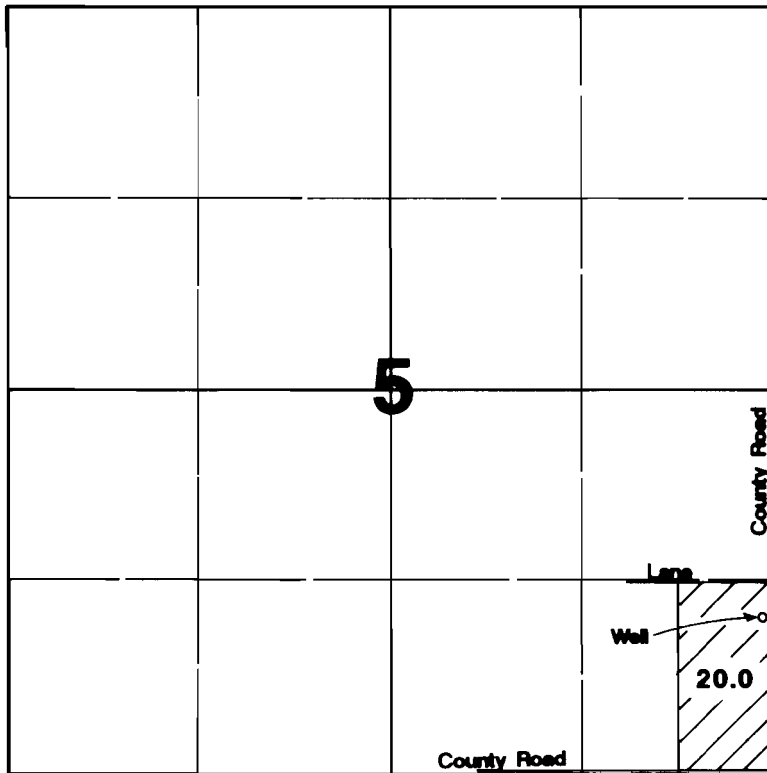

Well located 1120'N & 75'W from SE corner of Section 5.

Final Proof Survey

Application #: G-11704 Permit #: G-11025

In Name Of

Iseli Nursery

Surveyed on October 26, 1993 by JM Schuetta

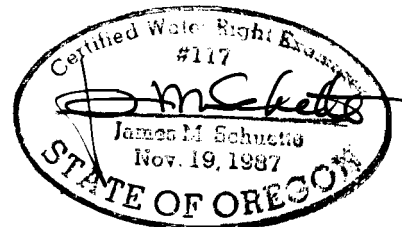

THIS MAP WAS PREPARED FOR THE PURPOSE OF IDENTIFYING THE LOCATION OF A WATER RIGHT ONLY AND IS NOT INTENDED TO PROVIDE LEGAL DIMENSIONS OR LOCATION OF PROPERTY OWNERSHIP LINES.