

FINAL PROOF SURVEY MAP  
 IN THE NAME OF R. S. RUDELLE

SECTION 33, T 27 S, R 14 W, W.M.  
 &  
 SECTION 4, T 28 S, R 14 W, W.M.

APPLICATION G-12006

PERMIT G-11045

RECEIVED

OCT - 1 1996

WATER RESOURCES DEPT.  
 SALEM, OREGON

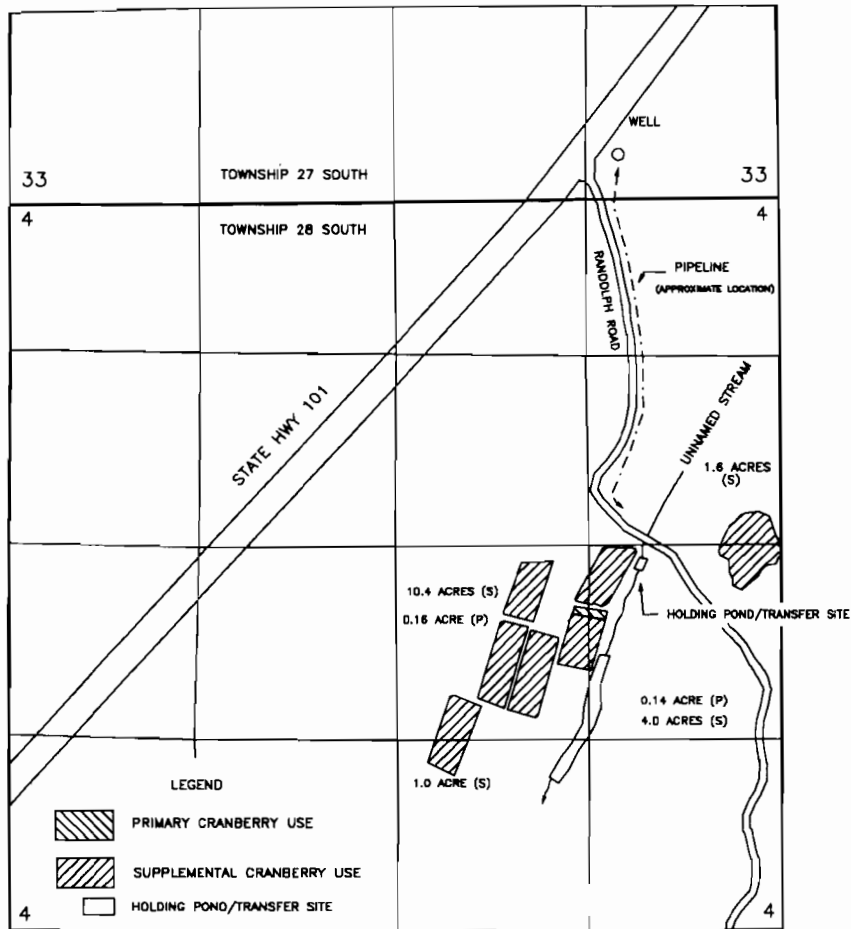

THE WELL IS LOCATED 300 FEET NORTH AND 1100 FEET WEST FROM THE SOUTHEAST CORNER OF SECTION 33 AND WITHIN THE SE $\frac{1}{4}$ SE $\frac{1}{4}$  OF SECTION 33, TOWNSHIP 27 SOUTH, RANGE 14 WEST, W.M., COOS COUNTY.

THE PURPOSE OF THIS MAP IS TO IDENTIFY THE LOCATION OF THE WATER RIGHT. IT IS NOT INTENDED TO PROVIDE INFORMATION RELATIVE TO THE LOCATION OF PROPERTY OWNERSHIP BOUNDARY LINES.

