

RECEIVED

AUG 2 1988

T5S, R2W, WM WATER RESOURCES DEPT.  
SALEM, OREGON

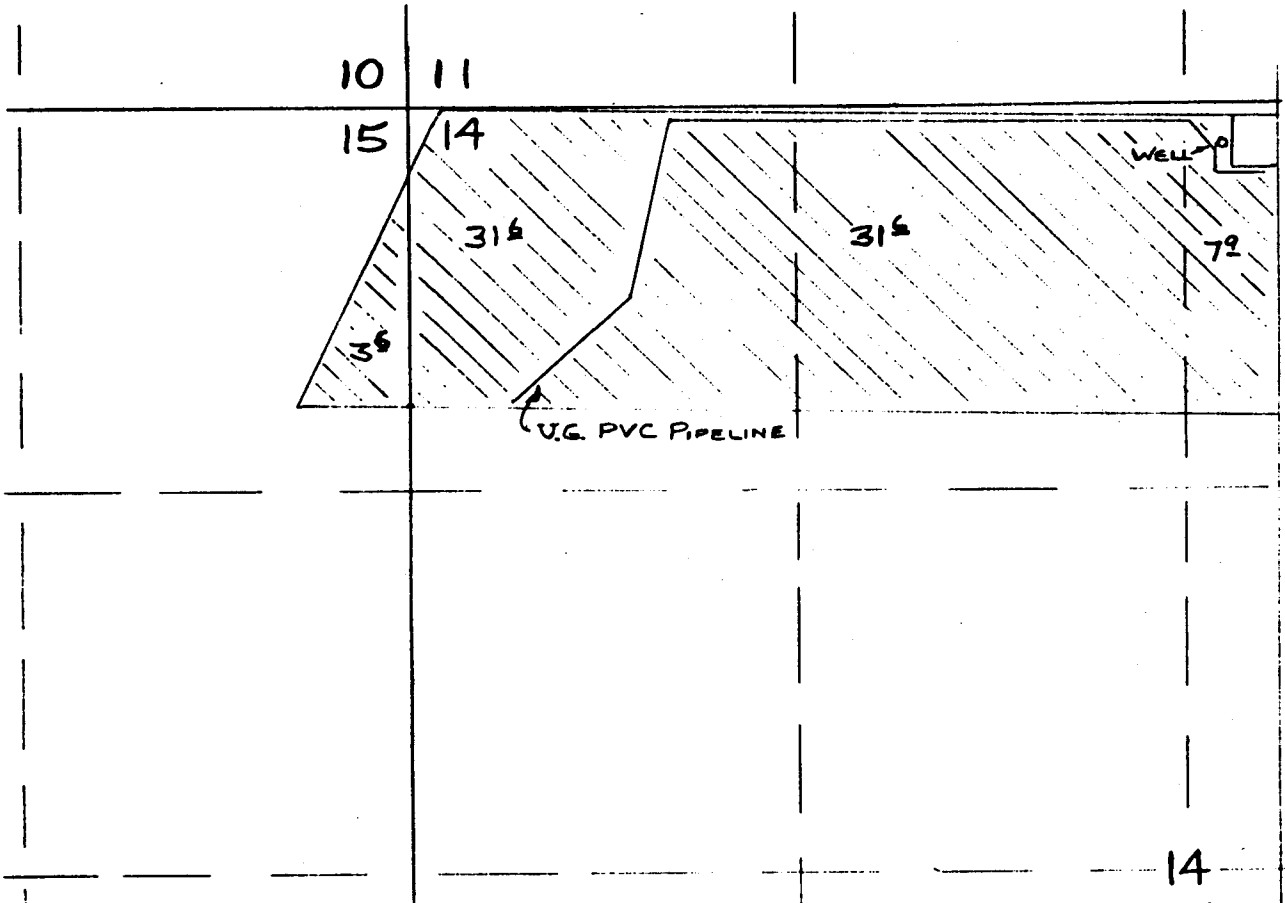

WELL LOC: 2786' EAST AND 100' SOUTH OF NW COR SEC 14

Application No. G-11838

Permit No. G11054

APPLICATION MAP

APPLICATION 

NOTE: MAP IS FOR  
PURPOSE OF IDENT-  
IFYING LOCATION OF  
WATER RIGHT AND HAS  
NO INTENT TO DIMEN-  
SION OR LOCATE PROPERTY  
OWNERSHIP LINES.

GAEL CUTSFORTH

SURVEYED JULY 28 1988 BY:

SCALE: 1 INCH = 660 FT

