

T.37 S., R.2 W., W.M.

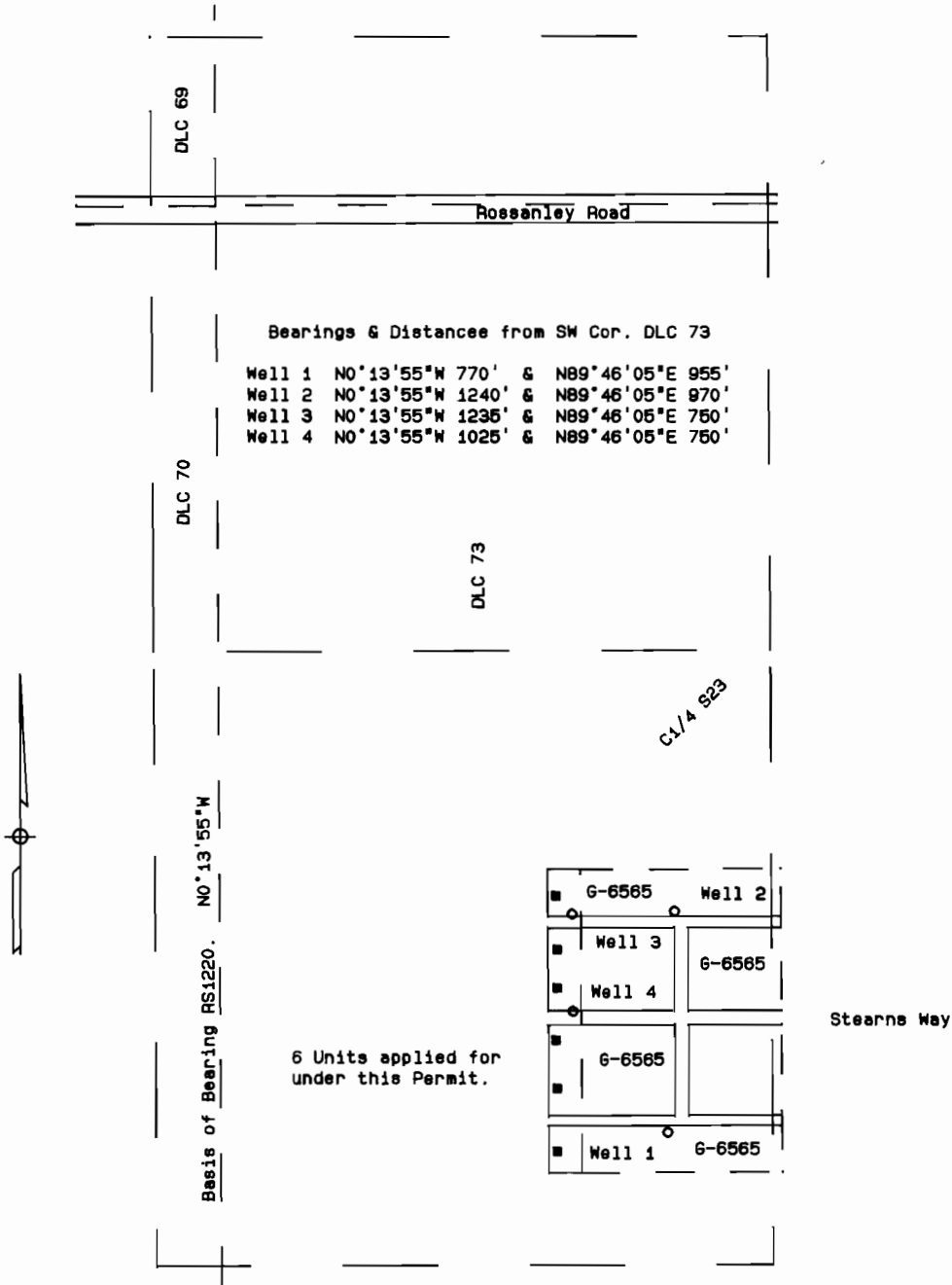

Bearings & Distances from SW Cor. DLC 73

- Well 1 N0°13'55"W 770' & N89°46'05"E 955'
- Well 2 N0°13'55"W 1240' & N89°46'05"E 970'
- Well 3 N0°13'55"W 1235' & N89°46'05"E 750'
- Well 4 N0°13'55"W 1025' & N89°46'05"E 750'

6 Units applied for under this Permit.

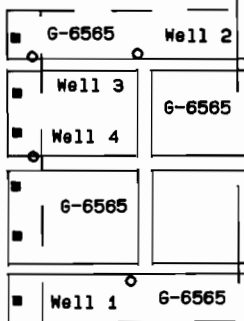

The preparation of this map was for the purpose of identifying the water right only & has no intent to provide dimension or location of property ownership lines.

SW Cor
DLC 73

FINAL PROOF MAP
under
Application No. G-11911 Permit No. G-11063
in name of

JOE E. and/or FRANCES M. BROOKS

Mapped April 12, 1993 Scale: 1" = 400'

Mapped by: L.J. Friar & Associates P.C.
Consulting Land Surveyors
304 South Holly Street
Medford, OR 97501
(503) 772-2782

