

T.7S., R.1W., W.M.

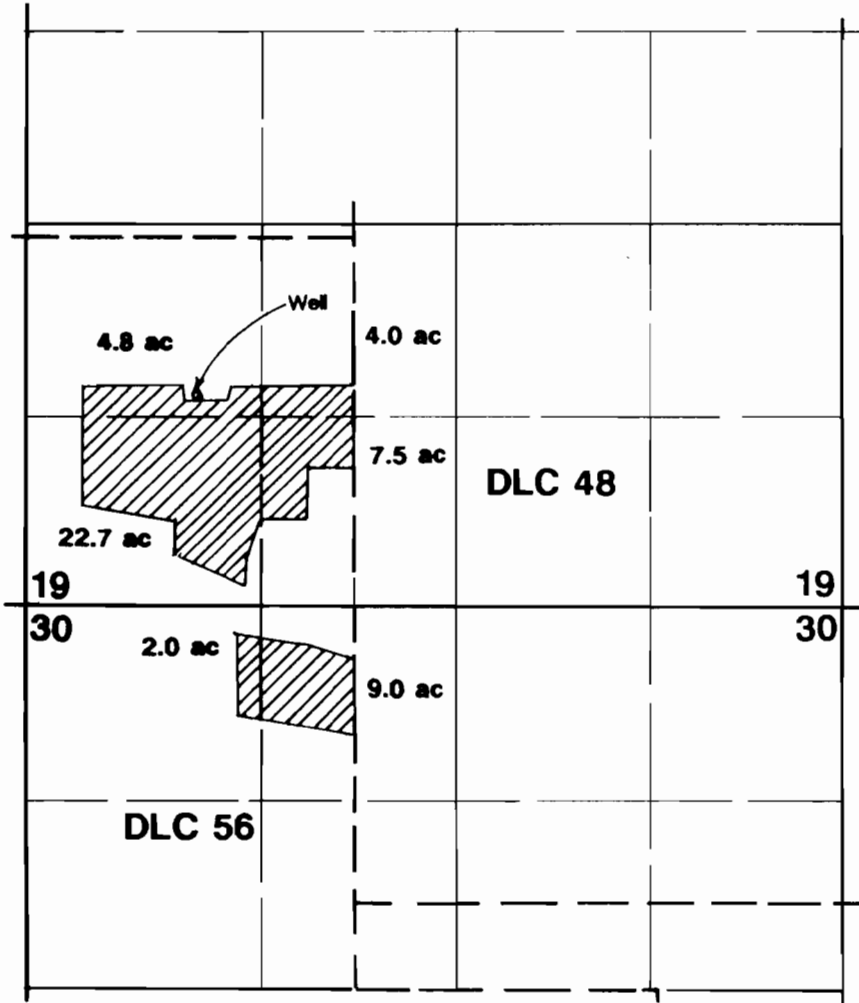

Well Located 1450'N & 1150'E from SW corner Section 19.



Area Irrigated



Final Proof Survey

Application #: G-12150

Permit #: G-11157

In Name Of

Michael Fordyce

Surveyed on September 6, 1994 by JM Schuette

THIS MAP WAS PREPARED FOR THE PURPOSE OF IDENTIFYING THE LOCATION OF A WATER RIGHT ONLY AND IS NOT INTENDED TO PROVIDE LEGAL DIMENSIONS OR LOCATION OF PROPERTY OWNERSHIP LINES.