

NE 1/4, NE 1/4 SECTION 1, T.1S., R.1W., W.M.  
WASHINGTON COUNTY, OREGON

36 31

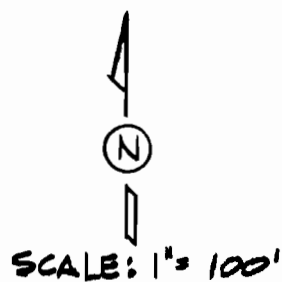

FINAL PROOF SURVEY

SURVEYED: SEPT. 14, 1993

PERMIT: G-11191

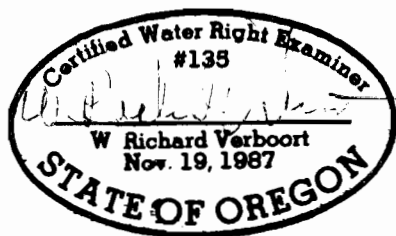

PREPARATION OF THIS MAP IS FOR THE PURPOSE OF IDENTIFYING THE LOCATION OF THE WATER RIGHT ONLY. THERE IS NO INTENT TO PROVIDE DIMENSIONS OR LOCATION OF PROPERTY OWNERSHIP LINES

IRRIGATION RE-LIFT STATION

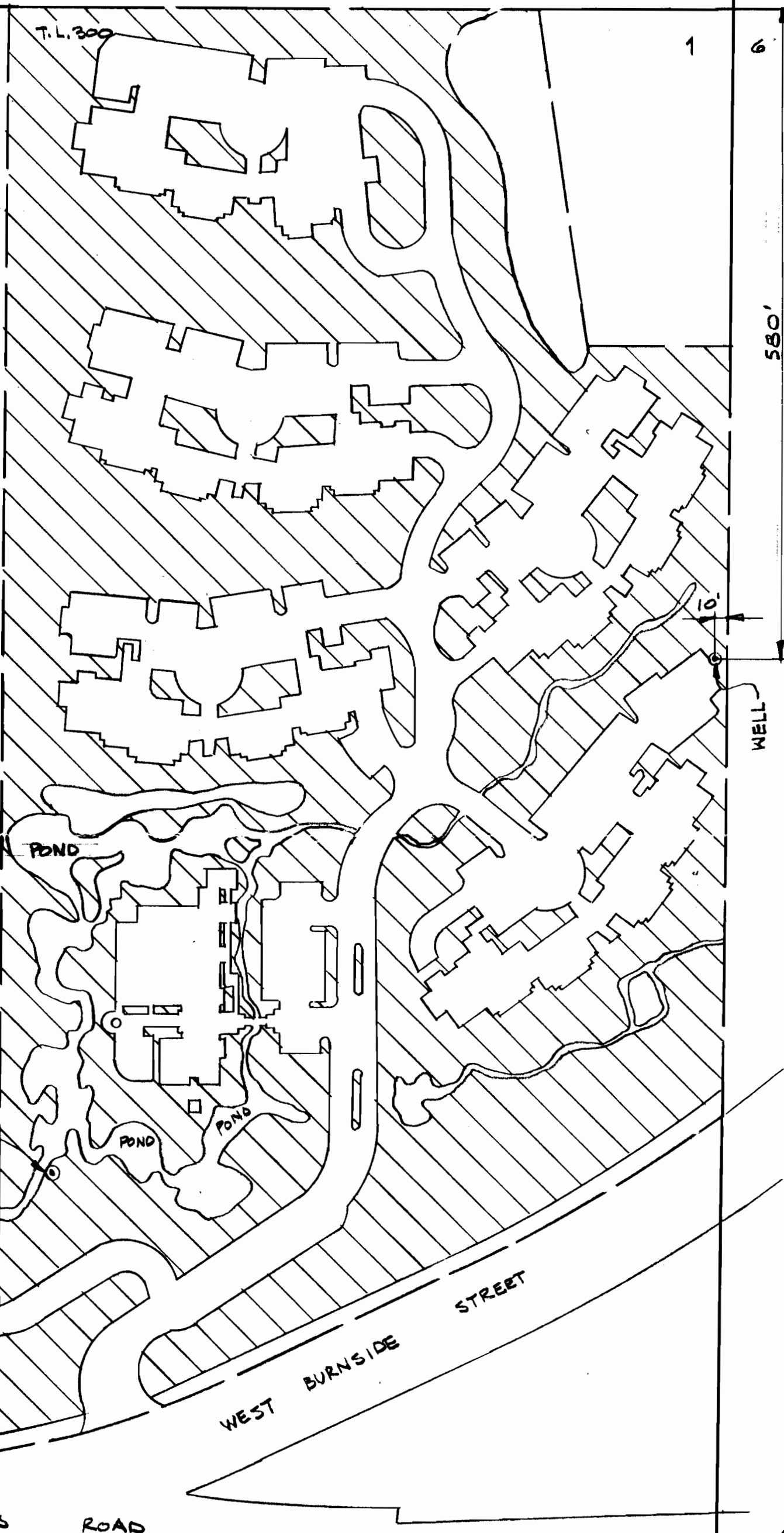
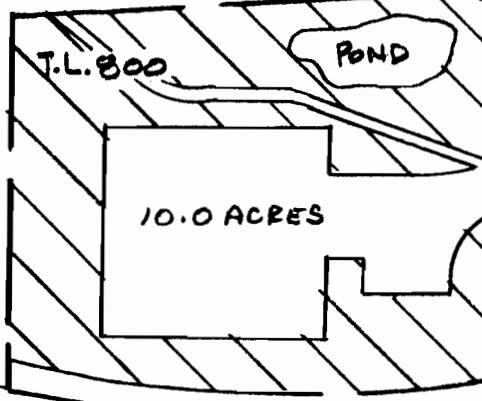

580'

**VERBOORT ENGINEERING**  
AGRICULTURE • CIVIL • WATER RESOURCES  
HILLSBORO, OREGON

	by	date
designed	WRV	9-19-93
drawn	JER	9-19-93
checked	WRV	9-19-93
drawing no.	93-B-20	
sheet no.	1/1	

CASCADE ESTATES?  
9400 S.W. BARNES ROAD  
PORTLAND, OR