

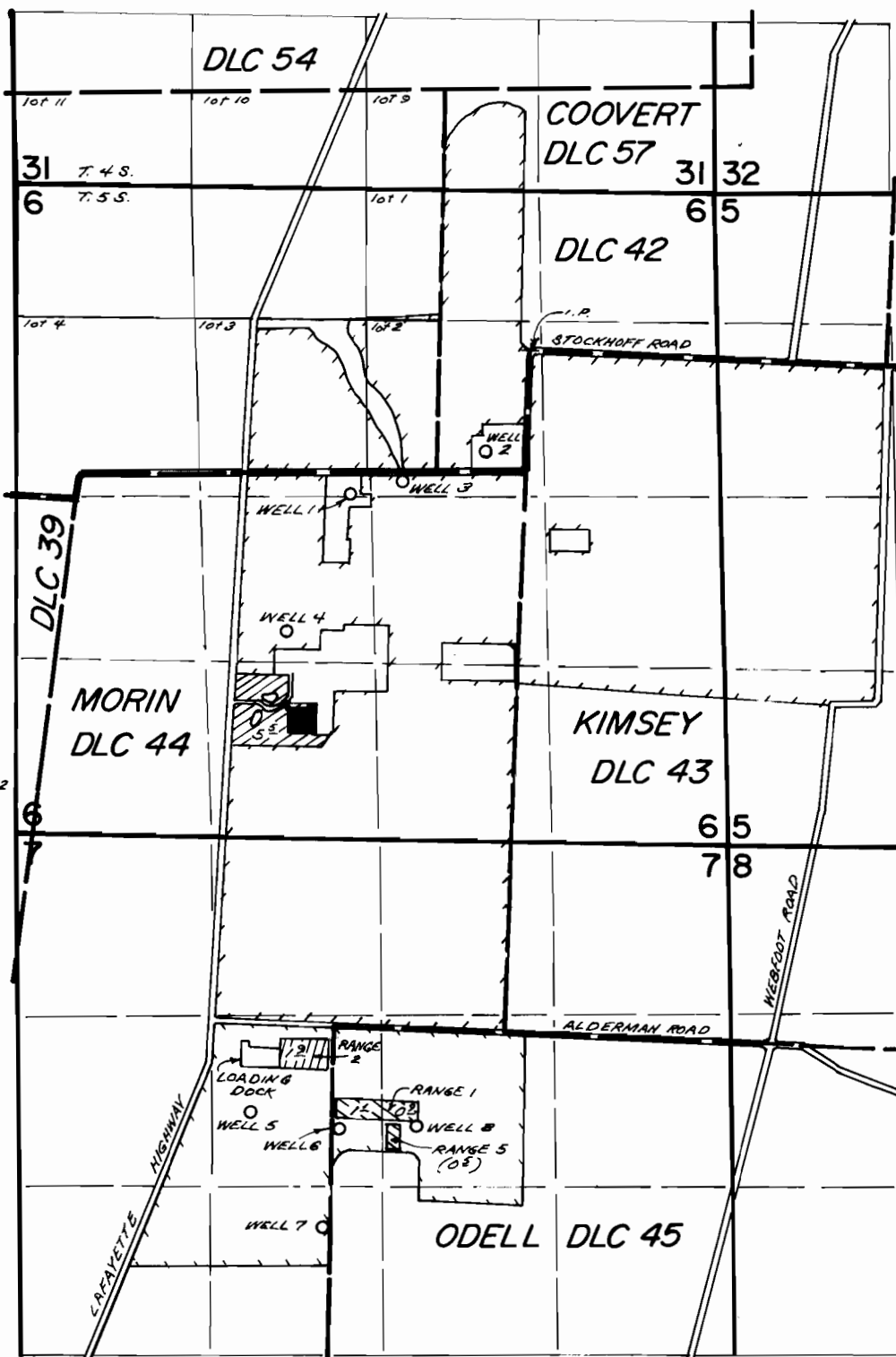



# Township 4 & 5 South, Range 3 West, W. M.



-  WELL 3  
PER. G-11272
-  WELL 5  
PER. G-11196
-  WELLS 6, 7, 8  
PER. G-11196
-  WELLS 1, 2, 4, 5  
PER. G-11196, G-11272  
MIXING FARM CHEM.  
AND FERT. AND HAND  
WATERING
-  WELLS 2, 4, 5  
PER. G-11196  
MIXING FARM CHEM.  
AND FERT.

- WELLS LOCATED:
- NO. 1  
1060' S. & 1390' W.
  - NO. 2  
740' S. & 440' W.
  - NO. 3  
960' S. & 1390' W.
  - NO. 4  
2090' S. & 2000' W.
  - NO. 5  
5780' S. & 2240' W.
  - NO. 6  
5930' S. & 1570' W.
  - NO. 7  
6080' S. & 1700' W.
  - NO. 8  
5920' S. & 960' W.
- ALL FROM NW COR.  
DLC 43.

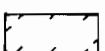
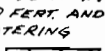
## FINAL PROOF SURVEY

under

Appl's. G-11961, G-11962, Per's. G-11196, G-11272

in name of

**MONROVIA NURSERY CO.**

November 18, 1994

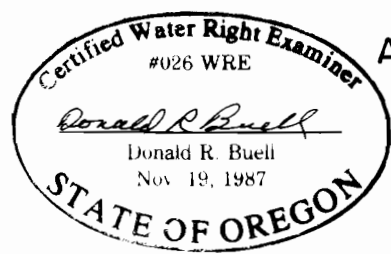

THIS MAP WAS PREPARED FOR THE PURPOSE OF IDENTIFYING THE LOCATION OF A WATER RIGHT ONLY AND IS NOT INTENDED TO PROVIDE LEGAL DIMENSIONS OR LOCATION OF PROPERTY OWNERSHIP LINES.