

# T.4S., R.1E., W.M.

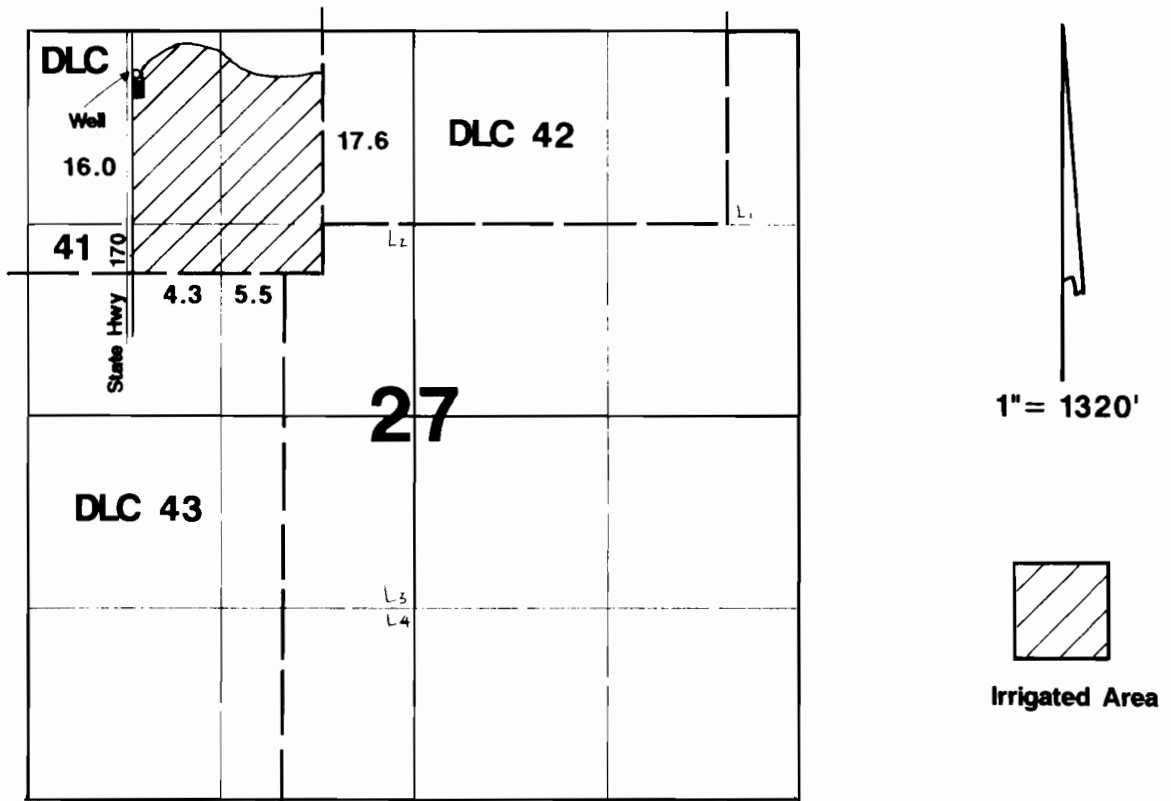

Well located 300'S & 748'E from NW corner Section 27.

## Final Proof Survey

Application #: G-12265 Permit #: G-11256

In Name Of

### Bronec Bros., Inc.

Surveyed on August 25, 1994 by JM Schuette

THIS MAP WAS PREPARED FOR THE PURPOSE OF IDENTIFYING THE LOCATION OF A WATER RIGHT ONLY AND IS NOT INTENDED TO PROVIDE LEGAL DIMENSIONS OR LOCATION OF PROPERTY OWNERSHIP LINES.

