

FINAL PROOF MAP

IN THE NAME OF



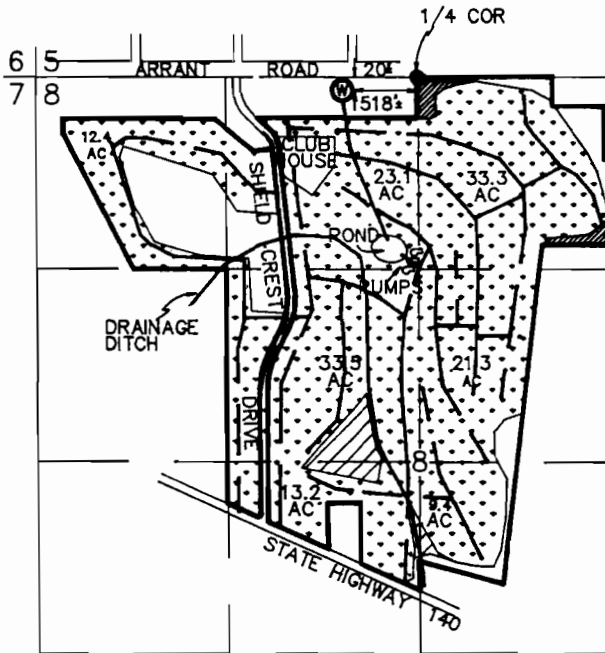

ROBERT AND HELEN CHEYNE
SHIELD CREST GOLF COURSE

LOCATED IN W 1/2 & W 1/2 E 1/2 SEC. 8, T.39S. R.10E., W.M.
KLAMATH COUNTY, OREGON

UNDER APPLICATION G-12271
PERMIT G-11263



SCALE: 1" = 1320'

-  AREA IRRIGATED BY HAND SPRINKLERS
-  AREA BEING IRRIGATED BY UNDERGROUND SPRINKLER SYSTEM
-  BURIED MAIN SUPPLY LINE - 8"
-  BURIED DISTRIBUTION LINES - 10", 8" & 6"
-  2" IRON PIPE

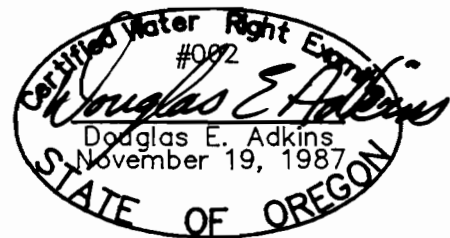

THIS MAP IS FOR THE PURPOSE OF IDENTIFYING THE LOCATION OF THE WATER RIGHT ONLY AND HAS NO INTENT TO PROVIDE DIMENSIONS OR LOCATION OF PROPERTY LINES.

MAP PREPARED BY: **ADKINS CONSULTING ENGINEERS INC.**
1453 ESPLANADE AVE.
KLAMATH FALLS, OREGON 97601
PHONE: (503) 884-4666

FEBRUARY 1992

JOB NO. 1248-01