

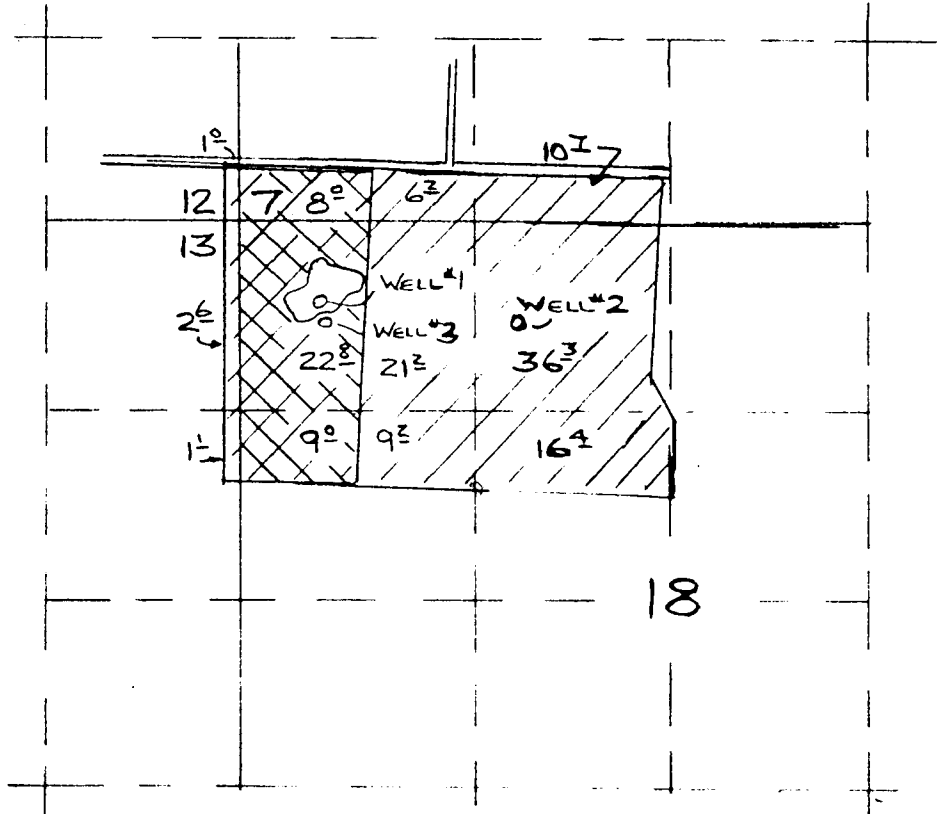

RECEIVED

OCT 23 1990

WATER RESOURCES DE
SALEM, OREGON

T7S. RIW. WM.



SUPPLEMENTAL SUPPLY FROM WELL 3 FOR 44.5 AC. 

ADDITIONAL SUPPLY FROM WELL 3 FOR 100.0 AC. 

WELL LOCATIONS:
 WELL*1 - 520'E + 520'So NW Cor Sec 18
 WELL*2 - 1850'E + 610'So NW Cor Sec 18
 WELL*3 - 490'E + 530'So NW Cor Sec 18

NOTE: MAP IS FOR PURPOSE OF IDENTIFYING LOCATION OF WATER RIGHT AND HAS NO INTENT TO DIMENSION OR LOCATE PROPERTY OWNERSHIP LINES.

APPLICATION MAP

Permit

G11269

APPLICATION 9-12260

MELVIN KING

OCT 4 1990

SCALE: 1 IN: 1320 FT

