

Application No. G 11985
Permit No. G11306

T. I. S., R. 2 & 3 W., W. M.

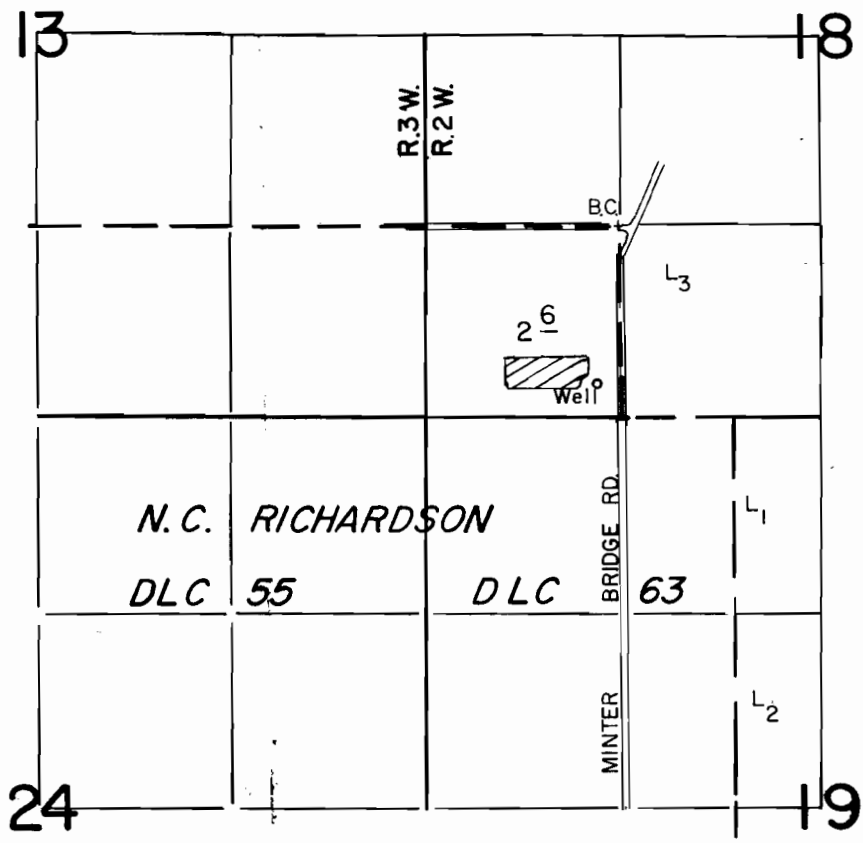

Well Loc. : 1080' S. & 160' W. from NE Cor. DLC 63.

Scale : 1" = 1320'

FINAL PROOF SURVEY UNDER

Application No. G-7475 Permit No. G-6959
IN NAME OF

KLAAS ELLERBROOK, JR.

Surveyed JULY 11, 1988, by T. Warren