

RECEIVED

MAR 16 1995

WATER RESOURCES DEPT
SALEM OREGON

T.5S., R.2W., W.M.

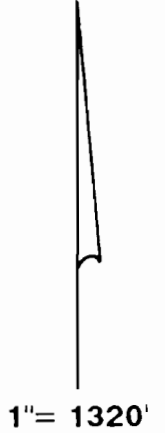
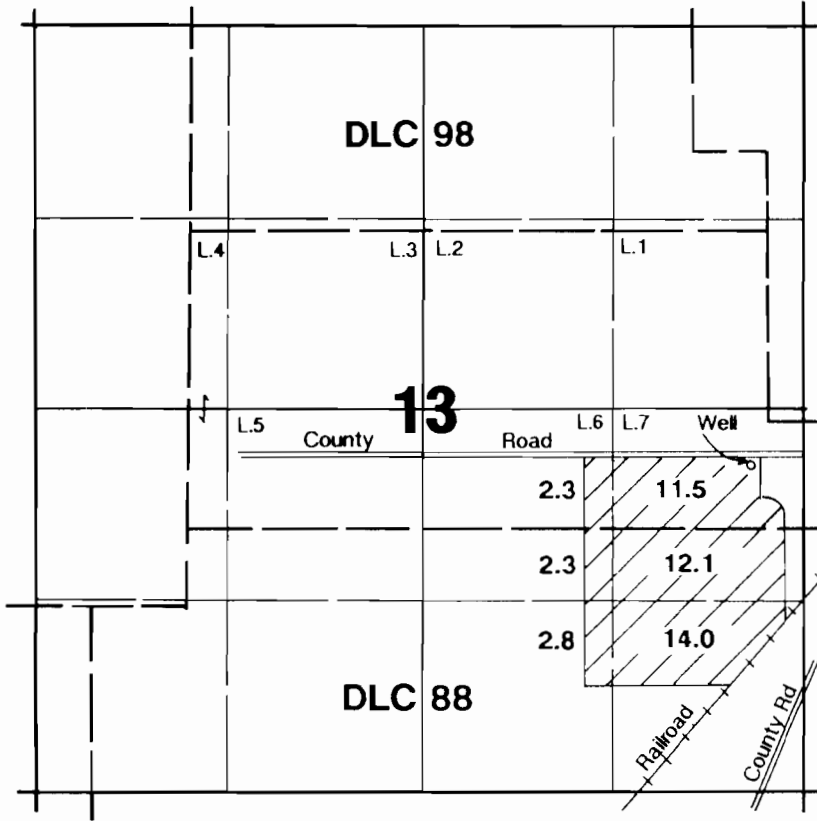

Well located 370'S & 330'W from E 1/4 corner of Section 13.

Final Proof Survey

Application #: G-12399 Permit #: G-11316

In Name Of

Elsie M. Berning

Surveyed on February 15, 1995 by JM Schuette

THIS MAP WAS PREPARED FOR THE PURPOSE OF IDENTIFYING THE LOCATION OF A WATER RIGHT ONLY AND IS NOT INTENDED TO PROVIDE LEGAL DIMENSIONS OR LOCATION OF PROPERTY OWNERSHIP LINES.

