

# T.7S., R.3W., W.M.

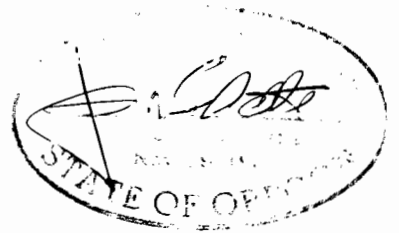
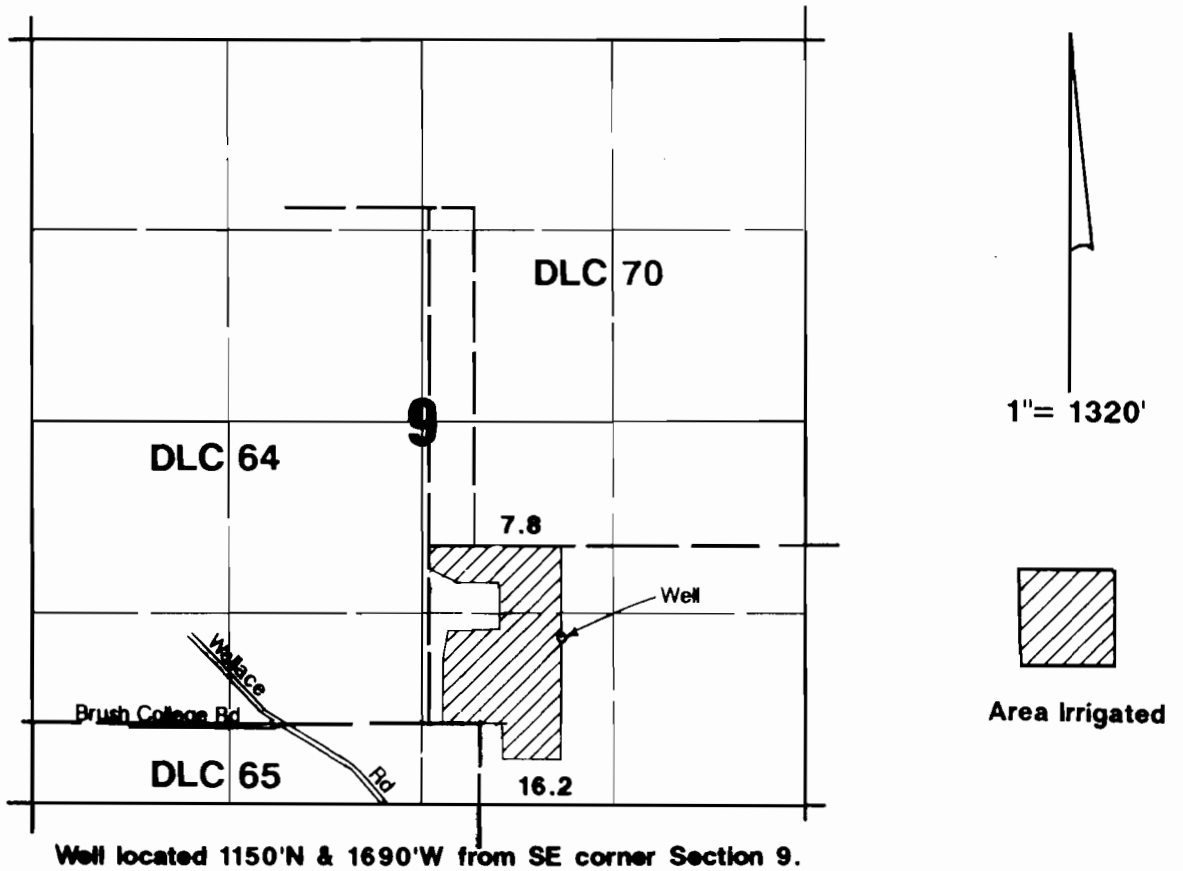

## Final Proof Survey

Application #G-12165 Permit #G-11330

In Name Of

# Don Meyer

Surveyed on October 28, 1994 by JM Schuette

THIS MAP WAS PREPARED FOR THE PURPOSE OF IDENTIFYING THE LOCATION OF A WATER RIGHT ONLY AND IS NOT INTENDED TO PROVIDE LEGAL DIMENSIONS OR LOCATION OF PROPERTY OWNERSHIP LINES.