

# APPLICATION MAP

IN THE NAME OF DELMER ROBISON

SECTION 7, T29S, R14W, W.M.

MAY 1987



1 INCH = 400 FEET

Application No. D-12101  
Permit No. G11390

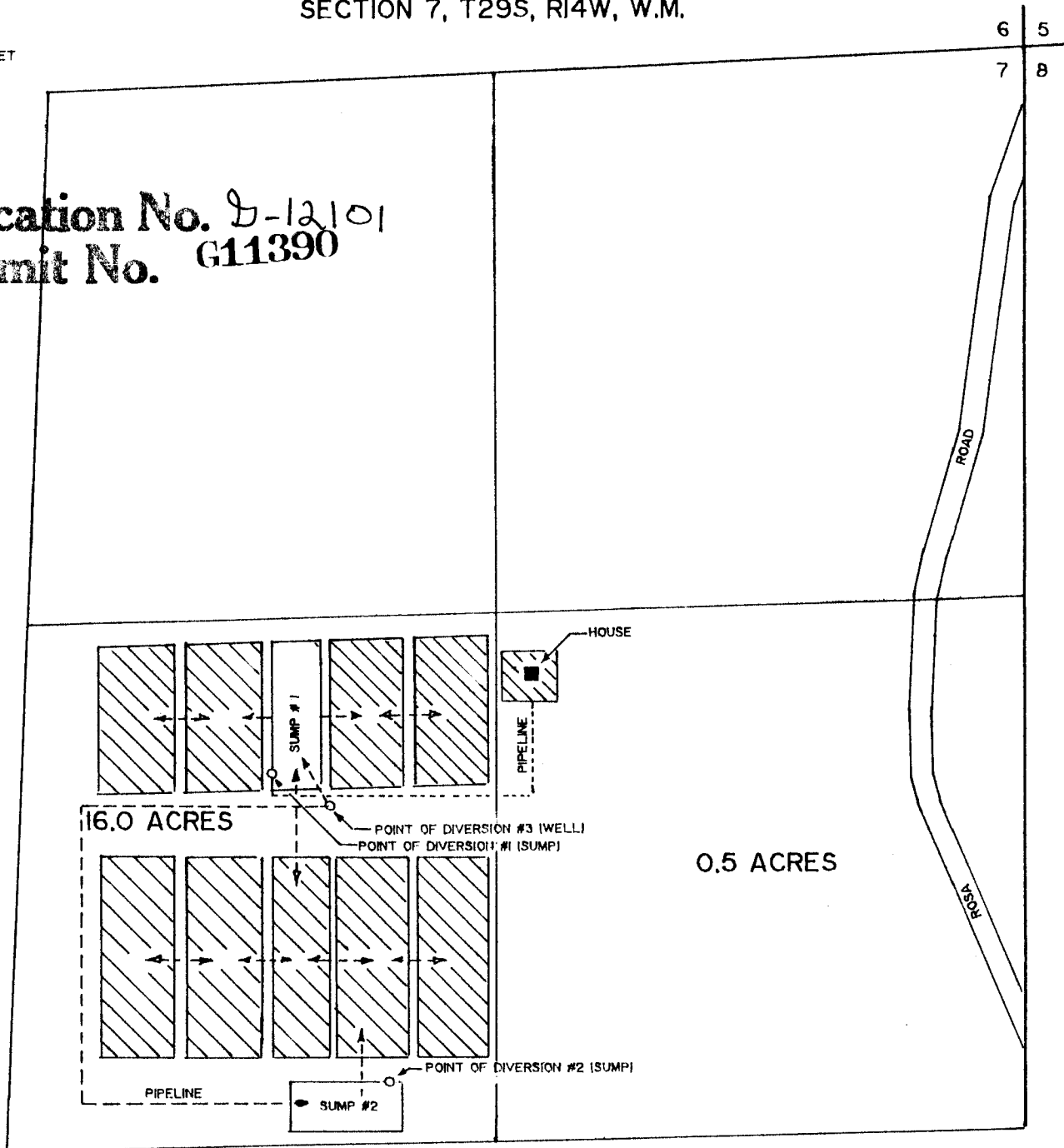

POD			POINT OF CALL	LOCATION
#1	1930 FT. SOUTH	1880 FT. WEST	NE COR. S 7	SW1/4 NE1/4 S 7
#2	2600 FT. SOUTH	1580 FT. WEST	NE COR. S 7	SW1/4 NE1/4 S 7
#3	1900 FT. SOUTH	1740 FT. WEST	NE COR. S 7	SW1/4 NE1/4 S 7

THE PURPOSE OF THIS MAP IS TO IDENTIFY THE LOCATION OF THE WATER RIGHT. IT IS NOT INTENDED TO PROVIDE INFORMATION RELATIVE TO THE LOCATION OF PROPERTY OWNERSHIP BOUNDARY LINES.

