

T.5S., R.2W., W.M.

RECEIVED

FEB 19 1991

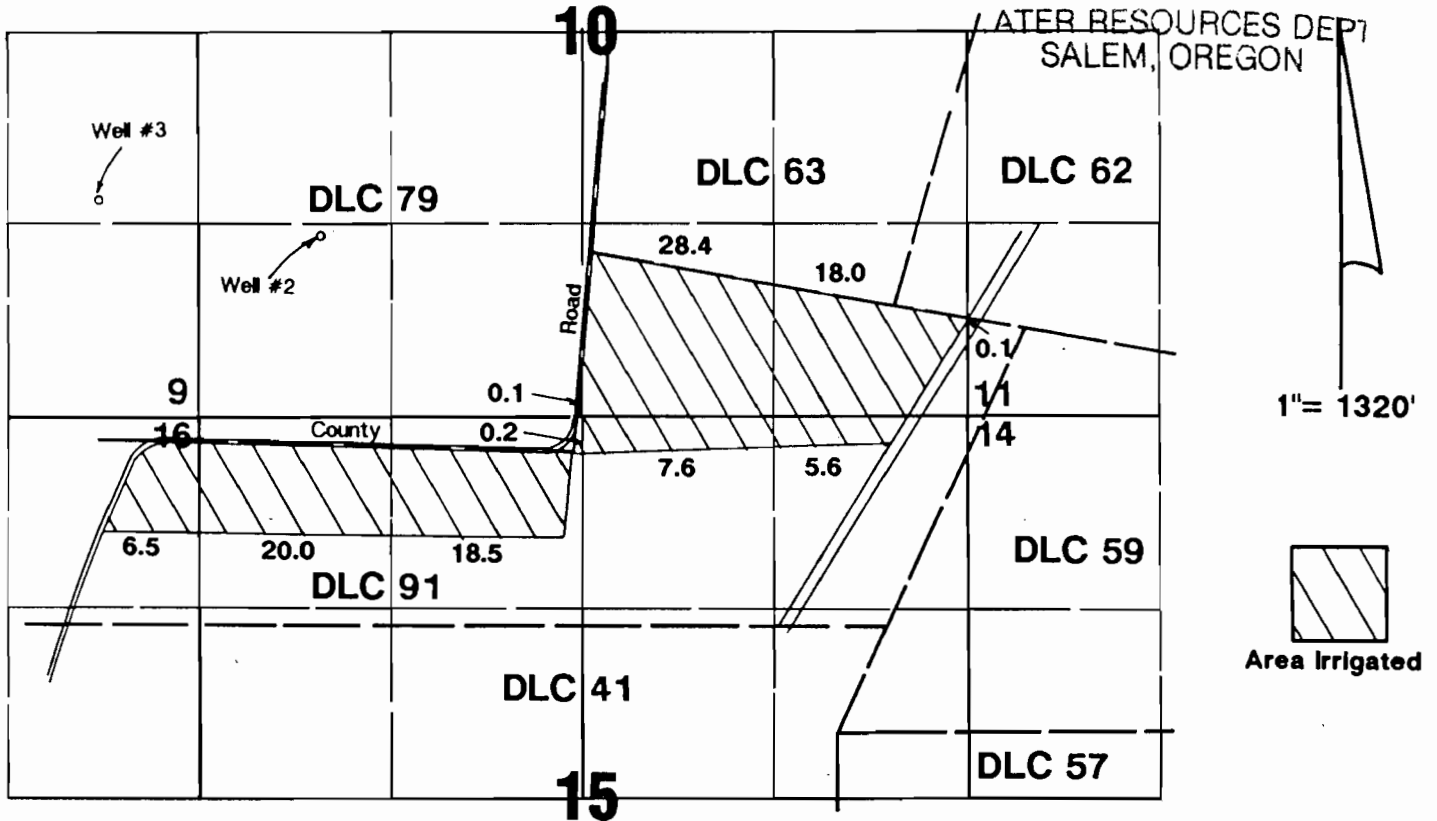

Well #2 located 1250'N & 850'E from the SW corner Section 10.

Well #3 located 1500'N & 660'W from the SW corner Section 10.

Ron DeConinck

Application Map

Application #: *9-12414*

Permit #: *0-11004*

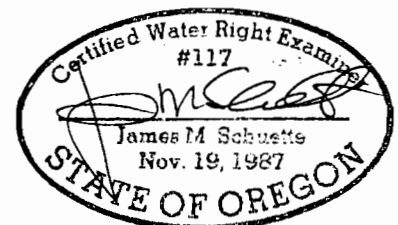

THIS MAP WAS PREPARED FOR THE PURPOSE OF IDENTIFYING THE LOCATION OF A WATER RIGHT ONLY AND IS NOT INTENDED TO PROVIDE LEGAL DIMENSIONS OR LOCATION OF PROPERTY OWNERSHIP LINES.