

T. 5 N., R. 28 E., W.M.

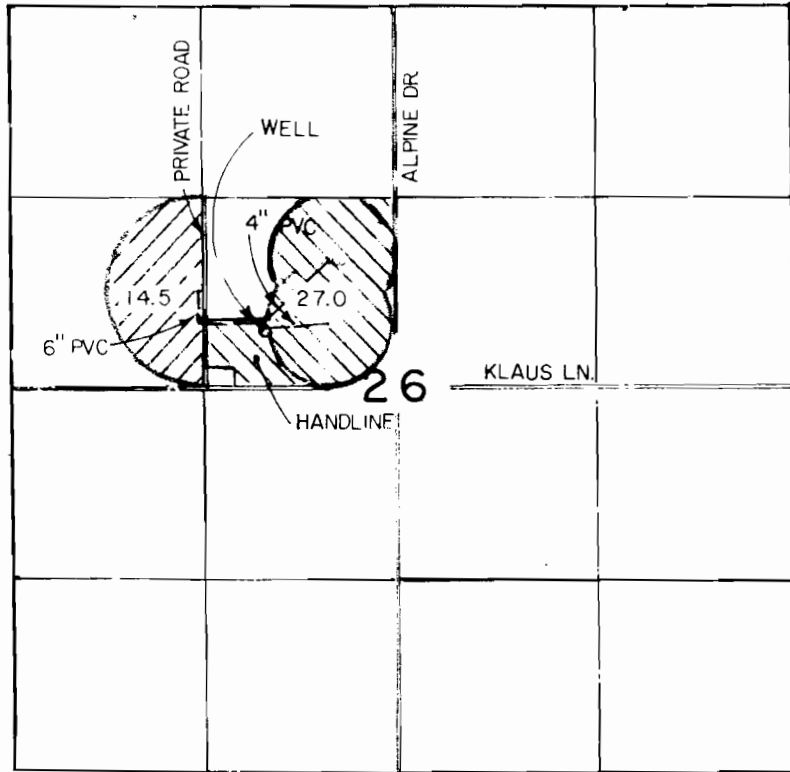

SCALE 1" = 1320'



WELL LOCATED 400' N & 1750' E FROM W 1/4 CORNER.

FINAL PROOF SURVEY

UNDER

Application No. G-12076

Permit No. G-11406

IN NAME OF

W. BRYAN & LOU ANN WOLFE

and

ROBERT & DOROTHY GREENWOOD

THIS MAP IS FOR THE PURPOSE OF IDENTIFYING THE LOCATION OF WATER RIGHTS ONLY AND IS NOT INTENDED TO PROVIDE LEGAL DIMENSIONS OR LOCATIONS OF PROPERTY OWNERSHIP LINES.

