

T.6S., R.2W., W.M.

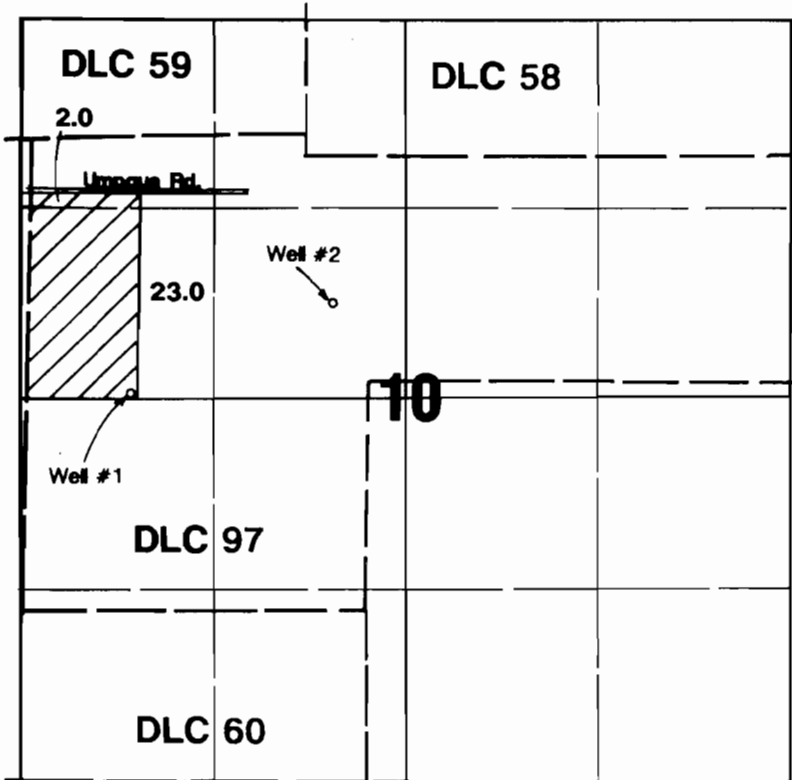

Well #1 located 1498'N & 1620'W from most southerly SE corner DLC 97.
Well #2 located 2120'N & 230'W from most southerly SE corner DLC 97.



1" = 1320'

Area Irrigated



Wells #1 & #2

RECEIVED

JUL 25 1996

WATER RESOURCES DEPT.
SALEM, OREGON

Final Proof Survey

Application #G-12470

Permit #G-11414

In Name Of

George J. Hauptman

Surveyed on July 6, 1996 by JM Schuette

THIS MAP WAS PREPARED FOR THE PURPOSE OF IDENTIFYING THE LOCATION OF A WATER RIGHT ONLY AND IS NOT INTENDED TO PROVIDE LEGAL DIMENSIONS OR LOCATION OF PROPERTY OWNERSHIP LINES.

