

Application No. G-12687

Permit No. G11467 R4W W.M.

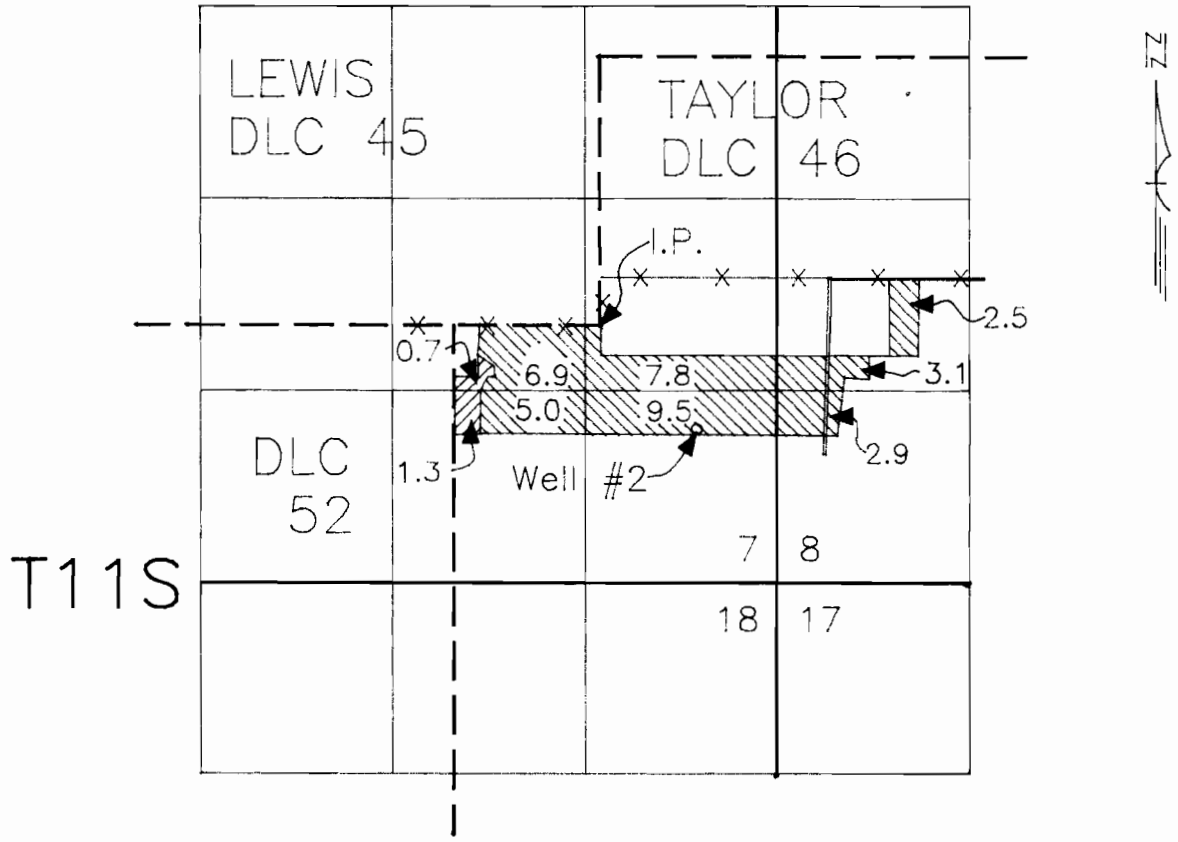

PLANT MATERIALS CENTER
USDA-SOIL CONSERVATION SERVICE
CORVALLIS, OREGON
[OSU - SCHMIDT AND HYSLOP]
FIELD LABORATORIES

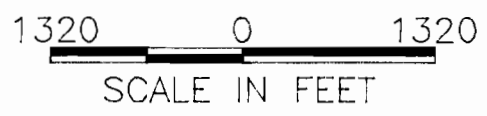
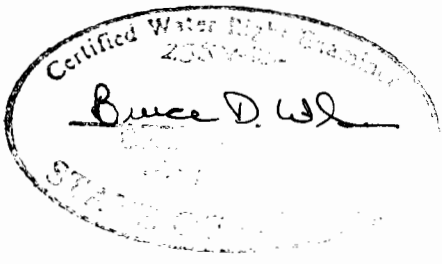

Primary - [hatched box]
Supplemental to Permit G-2567 - [cross-hatched box]

Well #2 is located 656 ft. E & 675 ft. S from the most southerly S.E. corner of Lewis DLC 45 marked with an iron pipe (I.P.).