

T.7S., R.2W., W.M.

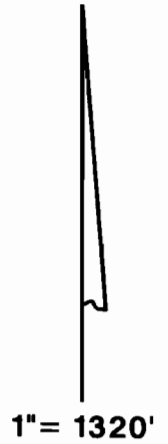
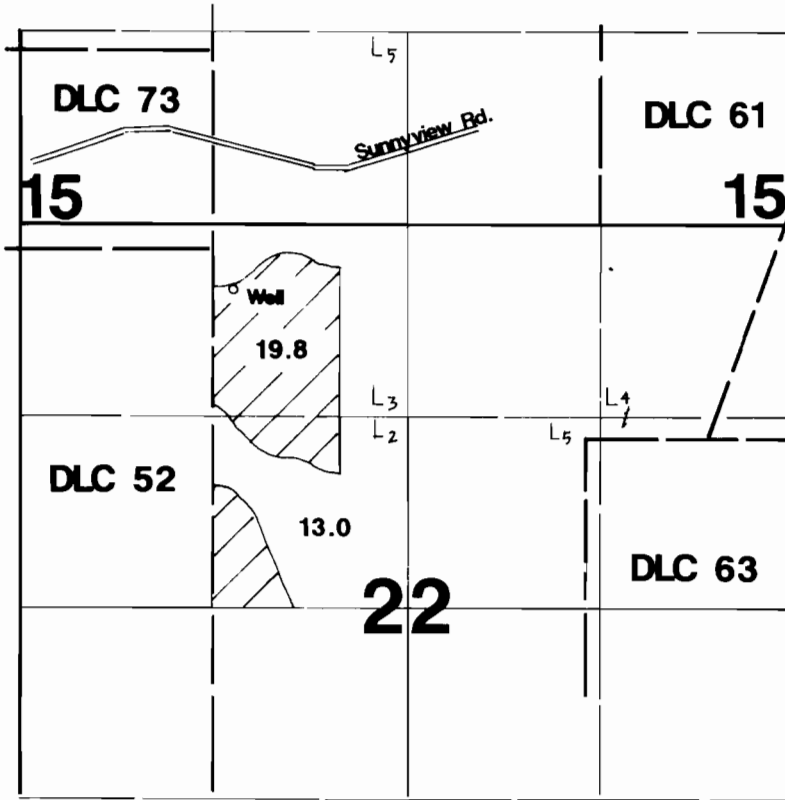

Well is located 1455'E & 440'S of NW corner Section 22.

Final Proof Survey

Application #: G-12144 Permit #: G-11473

In Name Of

Harlan Warnick

Surveyed on August 20, 1996 by JM Schuette

RECEIVED

AUG 29 1996

WATER RESOURCES DEPT
SALEM, OREGON

THIS MAP WAS PREPARED FOR THE PURPOSE OF IDENTIFYING THE LOCATION OF A WATER RIGHT ONLY AND IS NOT INTENDED TO PROVIDE LEGAL DIMENSIONS OR LOCATION OF PROPERTY OWNERSHIP LINES.

