

RECEIVED

SEP 16 1997

WATER RESOURCES DEPT.
SALEM, OREGON

T.5S., R.1W., W.M.

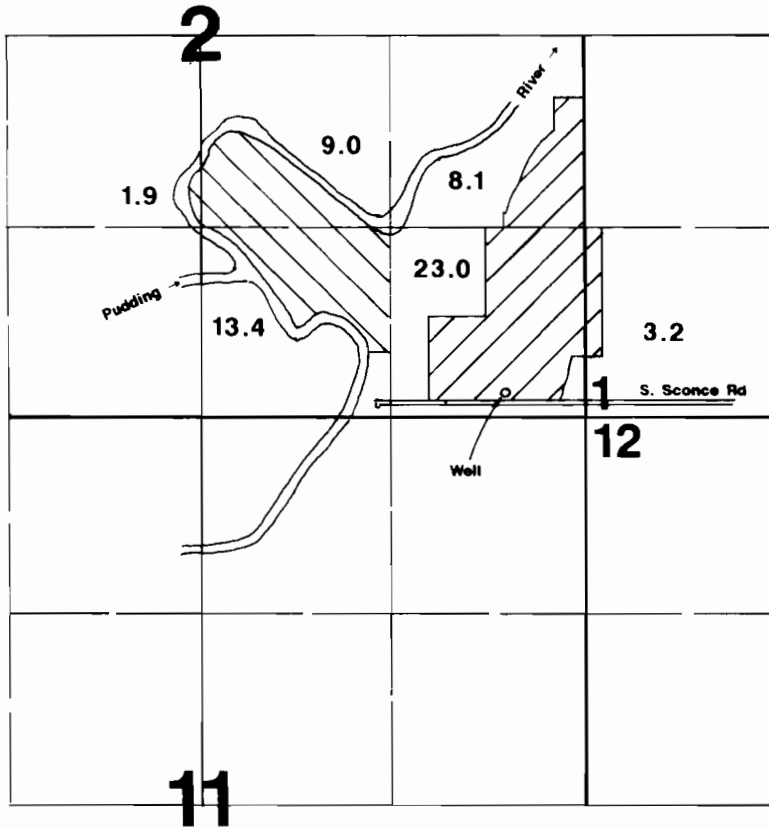

Area Irrigated

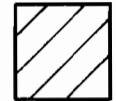

Nursery Operations

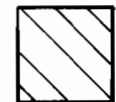

Irrigation

Well located 180'N & 500'W from SE corner Section 2.

Final Proof Survey

Application #: G-12057

Permit #: G-11635

In Name Of

Raymond Schwabauer

Surveyed on August 12, 1997 by JM Schuette

THIS MAP WAS PREPARED FOR THE PURPOSE OF IDENTIFYING THE LOCATION OF A WATER RIGHT ONLY AND IS NOT INTENDED TO PROVIDE LEGAL DIMENSIONS OR LOCATION OF PROPERTY OWNERSHIP LINES.

