

T. 9 S., R. 3 W., W. M.

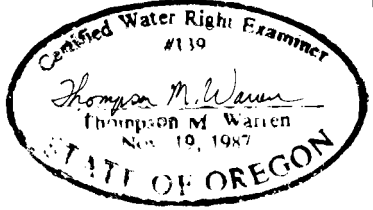

SCALE  
1" = 1320'



EXPIRES 6-30-2000

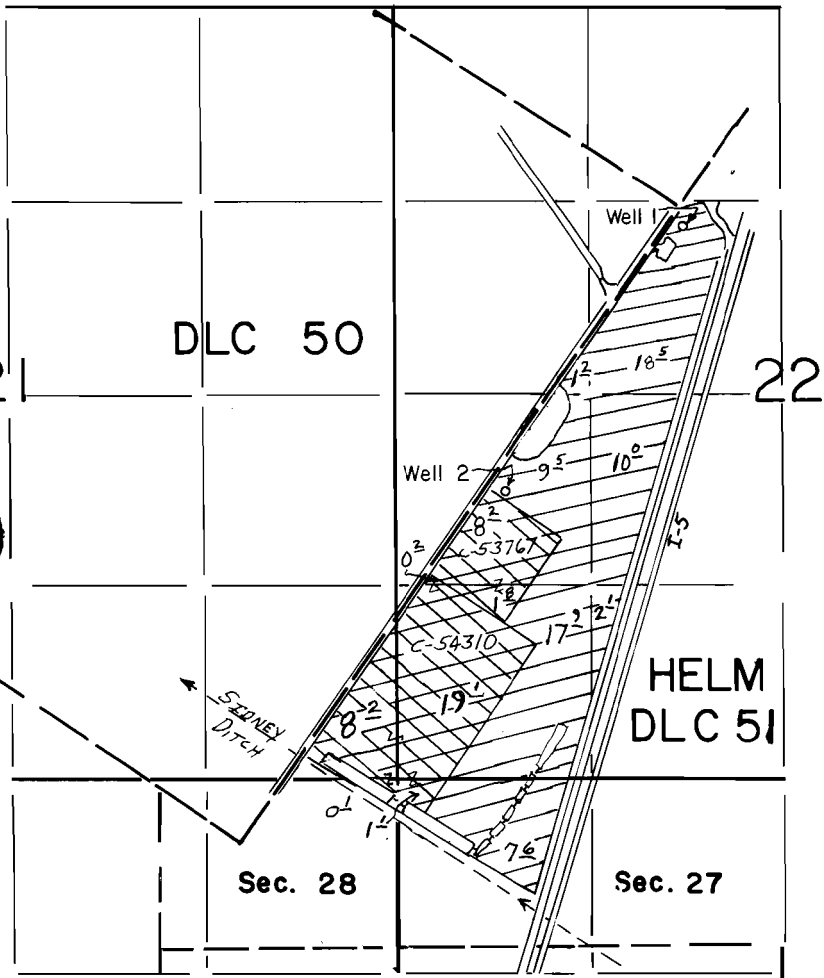

Well 1 Loc.: 150' S. & 10' E. from NE Cor. DLC 50  
Well 2 Loc.: 2400' N & 1840' E. from SE Cor. DLC 50

THIS MAP WAS PREPARED SOLELY FOR THE PURPOSE OF DEPICTING THE LOCATION OF A WATER RIGHT, AND HAS NO INTENTION OF BEING USED TO DETERMINE REAL PROPERTY BOUNDARIES.

AGRICULTURE USE  
("NURSERY OPERATIONS")  
&  
SUPPLEMENTAL IRRIGATION

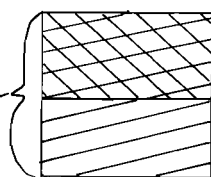

→ PRIMARY FROM C.W.R. #'S 53767 + 54310  
→ SUPPLEMENTAL TO A# 72403

### FINAL PROOF SURVEY UNDER

App. G-12913      Permit G-11671

HAROLD M. MILLER

Surveyed 9/19/98 by T.M. Warren

RECEIVED

SEP 29 1998

WATER RESOURCES DEPT  
STATE OF OREGON