

THE THREE WELLS ARE LOCATED IN THE
 SW 1/4 OF NW 1/4 OF SECTION 16
 TOWNSHIP 3 SOUTH, RANGE 8 EAST of the WM
 CLACKAMAS COUNTY, STATE OF OREGON

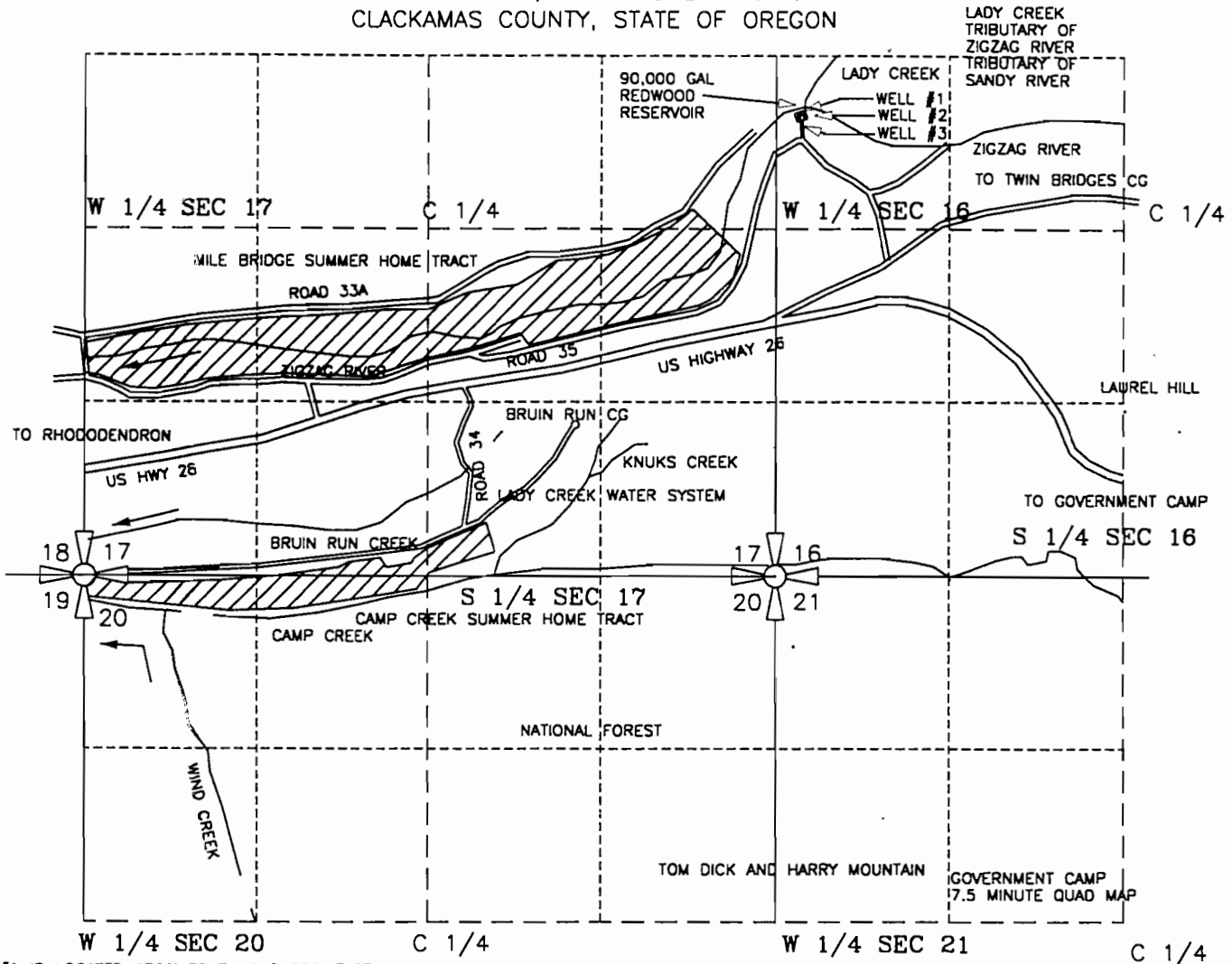

WELL #1 IS LOCATED 1780' SOUTH AND 220' EAST.
 WELL #2 IS LOCATED 1775' SOUTH AND 175' EAST.
 WELL #3 IS LOCATED 1800' SOUTH AND 180' EAST OF THE
 NORTHWEST CORNER OF SECTION 16, TOWNSHIP 3 SOUTH,
 RANGE 8 EAST OF THE WILLAMETTE MERIDIAN, CLACKAMAS
 COUNTY, STATE OF OREGON.

SIGNED: *3398*
 RENEWAL: DEC. 31, 1999

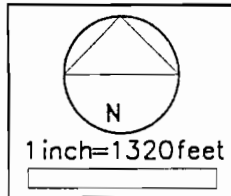
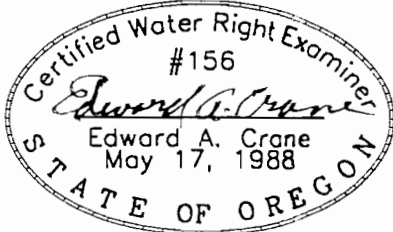

SURVEYED JAN. 23, 1998
 BY EDWARD A. CRANE, CWRE

MT HOOD NATIONAL FOREST
 FINAL PROOF SURVEY
 GROUNDWATER PERMIT G-11788

PREPARED BY EDWARD A. CRANE, CWRE

PREPARATION OF THIS MAP WAS FOR THE PURPOSE
 OF IDENTIFYING THE LOCATION OF THE WATER RIGHTS
 ONLY AND HAS NO INTENT TO PROVIDE DIMENSIONS
 OR LOCATION OF PROPERTY OWNERSHIP LINES.

H:\WP_PROVA\280-001\28000101.DWG

DATE
 MAR. 1998

PROJECT NO.
 280-001



CRANE & MERSETH
 Engineering/Surveying
 SUITE "D"
 6566 SE LAKE ROAD
 MILWAUKIE, OREGON 97222
 BUS: (503) 654-2005
 FAX: (503) 654-2575

APPLICATION FOR PERMIT NUMBER G-13132
 PERMIT NUMBER G-11788 IN THE NAME OF:

ZIG ZAG RANGER DISTRICT
 MT. HOOD NATIONAL FOREST
 U.S.D.A. - U.S. FOREST SERVICE

SHEET
 1/2

T3S R7E SEC 11 E1/2 OF SW 1/4
 T3S R7E SEC 13 W 1/2 OF NW 1/4 AND SE 1/4 OF NW 1/4 AND
 NE 1/4 OF SW 1/4 AND SE 1/4
 T3S R7E SEC 14 NE 1/4 AND NE 1/4 OF NW 1/4 AND N 1/2 OF SE 1/4
 T3S R7E SEC 24 NE 1/4 OF N3 1/4
 T3S R83 SEC 17 SE 1/4 OF NE 1/4 AND N 1/2 OF SW 1/4 AND
 SE 1/4 OF SW 1/4 AND N 1/2 OF SE 1/4 AND SW 1/4 OF SE 1/4
 T3S R8E SEC 18 SW 1/4 AND N 1/2 OF SE 1/4
 T3S R8E SEC 19 N 1/2 OF NW 1/4
 T3S R8E SEC 20 N 1/2 OF NW 1/4

ALL EAST OF WILLAMETTE MERIDIAN, CLACKAMAS COUNTY, OREGON

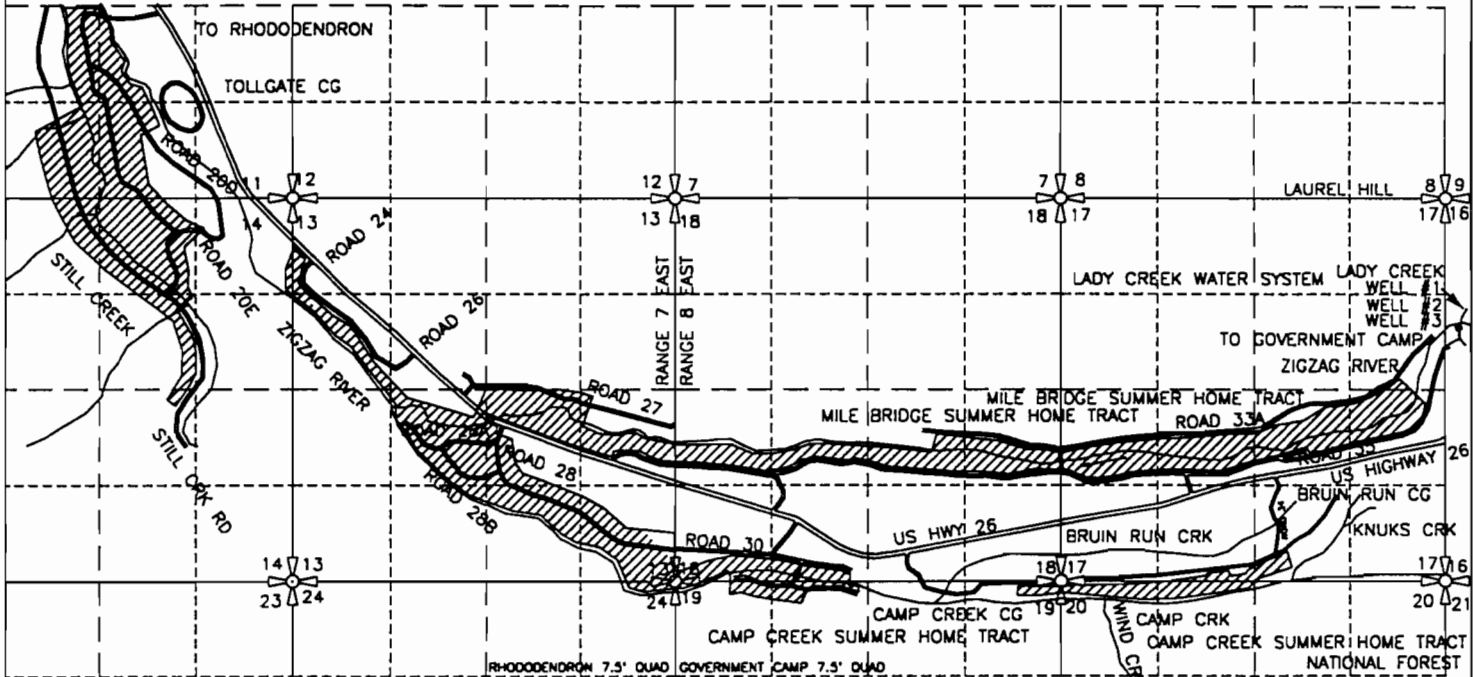

WELL #1 IS LOCATED 1780' SOUTH AND 220' EAST,
 WELL #2 IS LOCATED 1775' SOUTH AND 175' EAST,
 WELL #3 IS LOCATED 1800' SOUTH AND 180' EAST OF THE
 NORTHWEST CORNER OF SECTION 16, TOWNSHIP 3 SOUTH,
 RANGE 8 EAST OF THE WILLAMETTE MERIDIAN, CLACKAMAS
 COUNTY, STATE OF OREGON.

SIGNED: *3-3-98*
 RENEWAL: DEC. 31, 1999

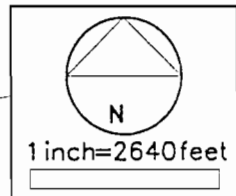
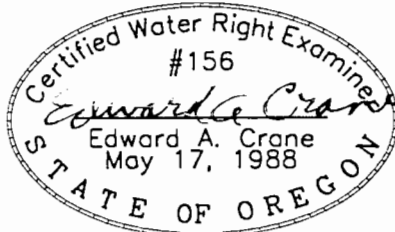

MT HOOD NATIONAL FOREST FINAL PROOF SURVEY GROUNDWATER PERMIT G-11788

PREPARED BY EDWARD A. CRANE, CWRE

PREPARATION OF THIS MAP WAS FOR THE PURPOSE
 OF IDENTIFYING THE LOCATION OF THE WATER RIGHTS
 ONLY AND HAS NO INTENT TO PROVIDE DIMENSIONS
 OR LOCATION OF PROPERTY OWNERSHIP LINES.

SURVEYED JAN. 23, 1998
 BY EDWARD A. CRANE, CWRE

H:\WP_PROJ\280-001\28000101.DWG

DATE
 MAR. 1998
 PROJECT NO.
 280-001



CRANE & MERSETH
 Engineering/Surveying
 SUITE "D"
 6566 SE LAKE ROAD
 MILWAUKIE, OREGON 97222
 BUS: (503) 654-2005
 FAX: (503) 654-2575

APPLICATION FOR PERMIT NUMBER G-13132
 PERMIT NUMBER G-11788 IN THE NAME OF:
 ZIG ZAG RANGER DISTRICT
 MT. HOOD NATIONAL FOREST
 U.S.D.A. - U.S. FOREST SERVICE

SHEET
 2/2