

T.1S. R.1E. NE 1/4 SECT. 4 W.M.



THE PURPOSE OF THIS MAP IS TO IDENTIFY THE WATER RIGHT. IT IS NOT INTENDED TO PROVIDE LEGAL DIMENSIONS OR TO SHOW THE LOCATION OF PROPERTY OWNERSHIP LINES.

- NEW WATER RIGHTS BEING APPLIED FOR UNDER THIS PERMIT
- EXISTING WATER RIGHTS FOR PSU WELL #2; REFERENCE FILE #G-4200 NO. G-3965.

NOTE: WELL NUMBERS CORRESPOND TO PORTLAND STATE UNIVERSITY WELL NUMBERING SYSTEM.

Handwritten signature

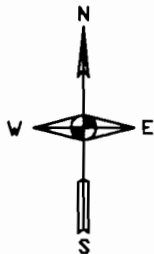

SCALE: 1" = 400'

WATER RESOURCES DEPT.
SALMON, OREGON

SEP 30 1998

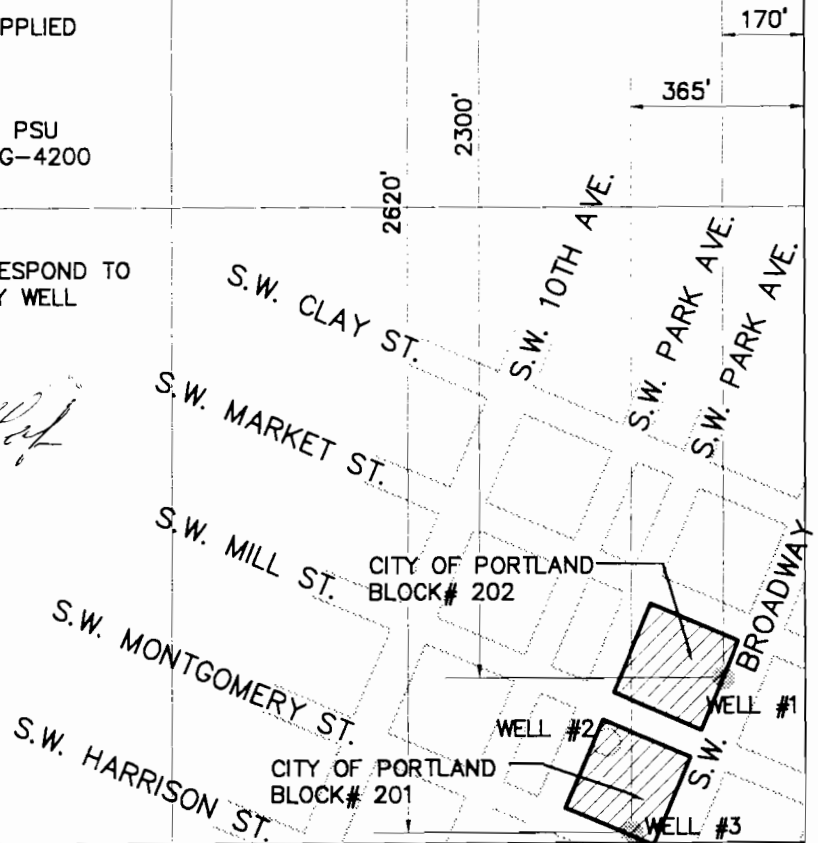

FINAL PROOF SURVEY

UNDER

APPLICATION NO. 612870 PERMIT NO. 611831

IN THE NAME OF

PORTLAND STATE UNIVERSITY

kpff

consulting engineers
portland oregon

PORTLAND STATE UNIVERSITY

DRAWN BY: SLC

JOB NO.: 91096

DATE: 9/20/98

91096-2

DRAWING NO.

RECEIVED