

T.4S., R.1W., W.M.

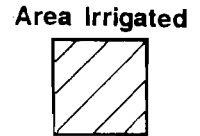
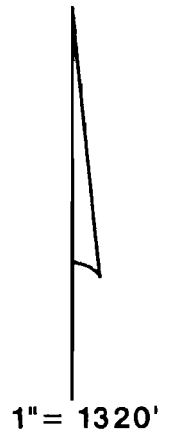
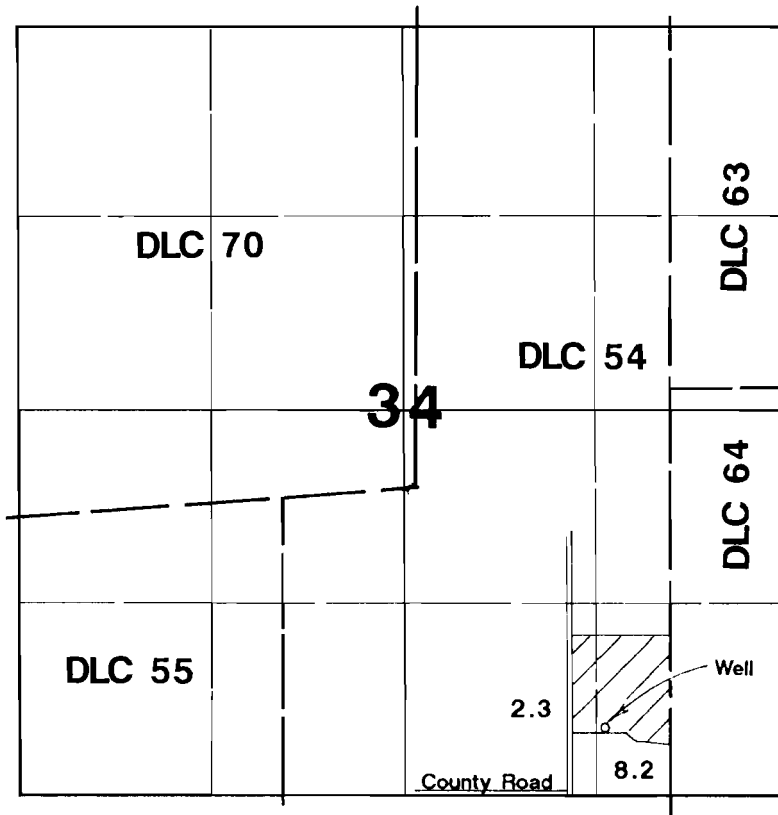

Well located 470'N & 1250'W from SE corner Section 34.

## Final Proof Survey

Application #: G-13035      Permit #: G-11833

In Name Of

# Lolita E. Carl

Surveyed on September 28, 1996 by JM Schuette

THIS MAP WAS PREPARED FOR THE PURPOSE OF IDENTIFYING THE LOCATION OF A WATER RIGHT ONLY AND IS NOT INTENDED TO PROVIDE LEGAL DIMENSIONS OR LOCATION OF PROPERTY OWNERSHIP LINES.

