

RECEIVED

FEB 14 1997

WATER RESOURCES DEPT.
SALEM, OREGON

T.6S., R.1W., W.M.

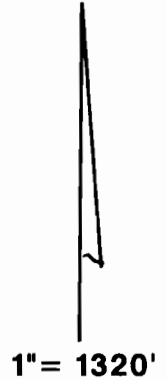
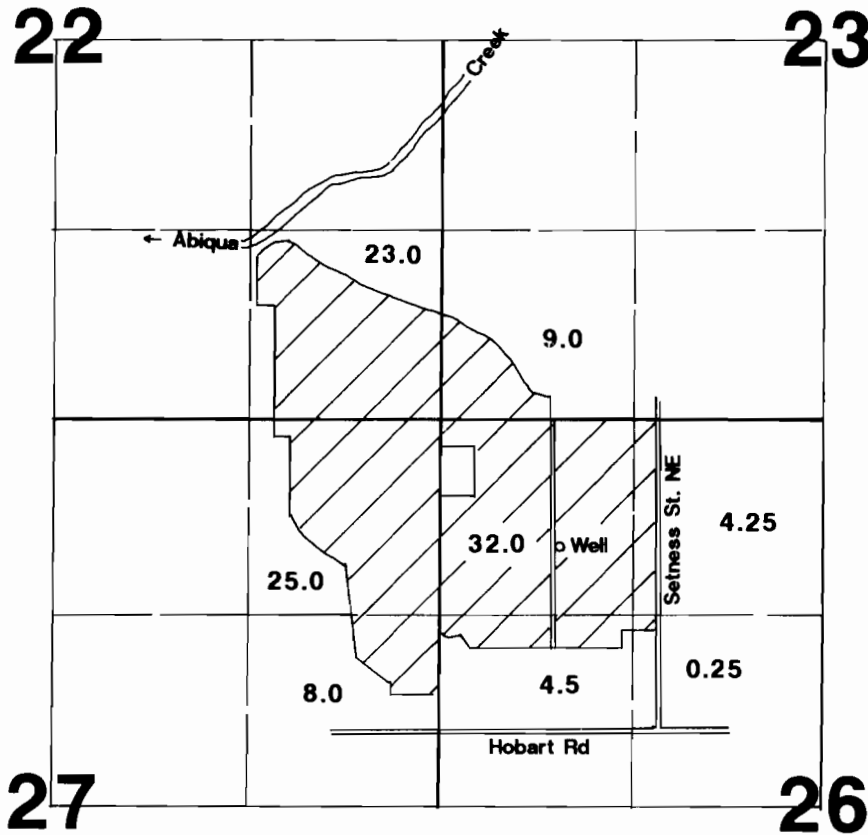

Well located 850'S & 820'E from NW corner Section 26.

Final Proof Survey

Application #: G-13147

Permit #: G-11844

In Name Of

Pembroke Farms

Surveyed on February 6, 1997 by JM Schuette

THIS MAP WAS PREPARED FOR THE PURPOSE OF IDENTIFYING THE LOCATION OF A WATER RIGHT ONLY AND IS NOT INTENDED TO PROVIDE LEGAL DIMENSIONS OR LOCATION OF PROPERTY OWNERSHIP LINES.

