

# T.6S., R.2W., W.M.

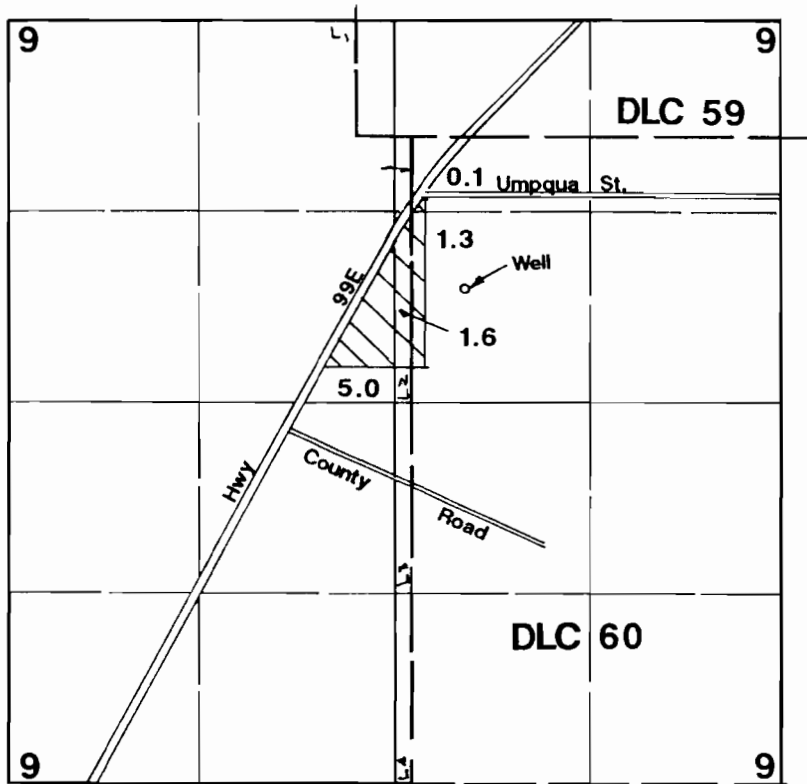

1" = 1320'

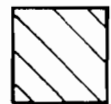

Area Irrigated

Well located 3440'N & 350'E from SW corner DLC 60.

**RECEIVED**

MAY 16 1997

WATER RESOURCES DEPT  
SALEM, OREGON

## Final Proof Survey

Application #: G-13499 Permit #: G-11866

In Name Of

# Ann Chambers

Surveyed on April 26, 1997 by JM Schuette

THIS MAP WAS PREPARED FOR THE PURPOSE OF IDENTIFYING THE LOCATION OF A WATER RIGHT ONLY AND IS NOT INTENDED TO PROVIDE LEGAL DIMENSIONS OR LOCATION OF PROPERTY OWNERSHIP LINES.

