

T.5S., R.2W., W.M.

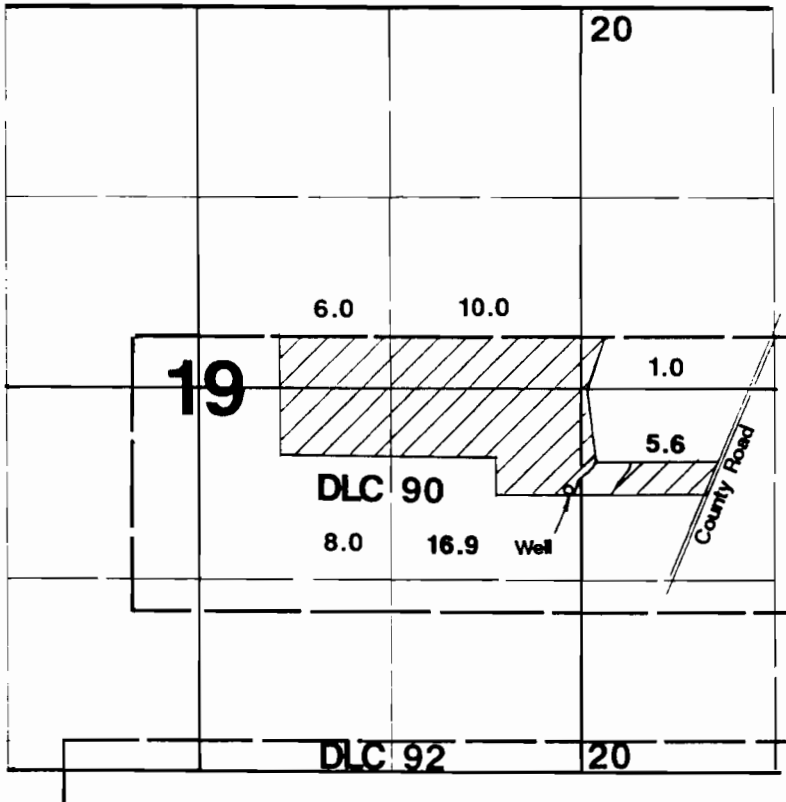

Well located 1946'N & 70'W from SE corner Section 19.

Final Proof Survey

Application #: G-13179 Permit #: G-11873

In Name Of

D.A. Nusom Orchards

RECEIVED

JUL 25 1996

WATER RESOURCES DEPT
SALEM, OREGON

Surveyed on July 12, 1996 by JM Schuette

THIS MAP WAS PREPARED FOR THE PURPOSE OF IDENTIFYING THE LOCATION OF A WATER RIGHT ONLY AND IS NOT INTENDED TO PROVIDE LEGAL DIMENSIONS OR LOCATION OF PROPERTY OWNERSHIP LINES.

