

T.6S., R.1W., W.M.

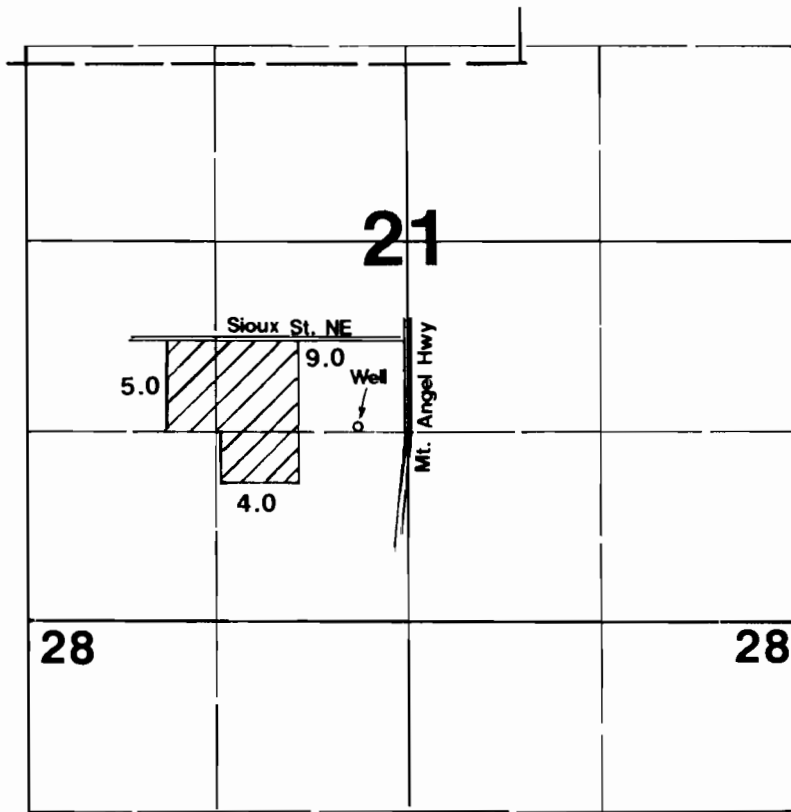

Well located 1300'S & 335'W from center of Section 21.

RECEIVED

JUL 31 1997

WATER RESOURCES DEPT
SALEM, OREGON

Final Proof Survey

Application #: G-13590

Permit #: G-11885

In Name Of

Robert Ditchen

Surveyed on July 24, 1997 by JM Schuette

THIS MAP WAS PREPARED FOR THE PURPOSE OF IDENTIFYING THE LOCATION OF A WATER RIGHT ONLY AND IS NOT INTENDED TO PROVIDE LEGAL DIMENSIONS OR LOCATION OF PROPERTY OWNERSHIP LINES.

