

RECEIVED

JUN 30 1999

T.8S. R.2E., W.M

WATER RESOURCES DEPT
SALEM, OREGON

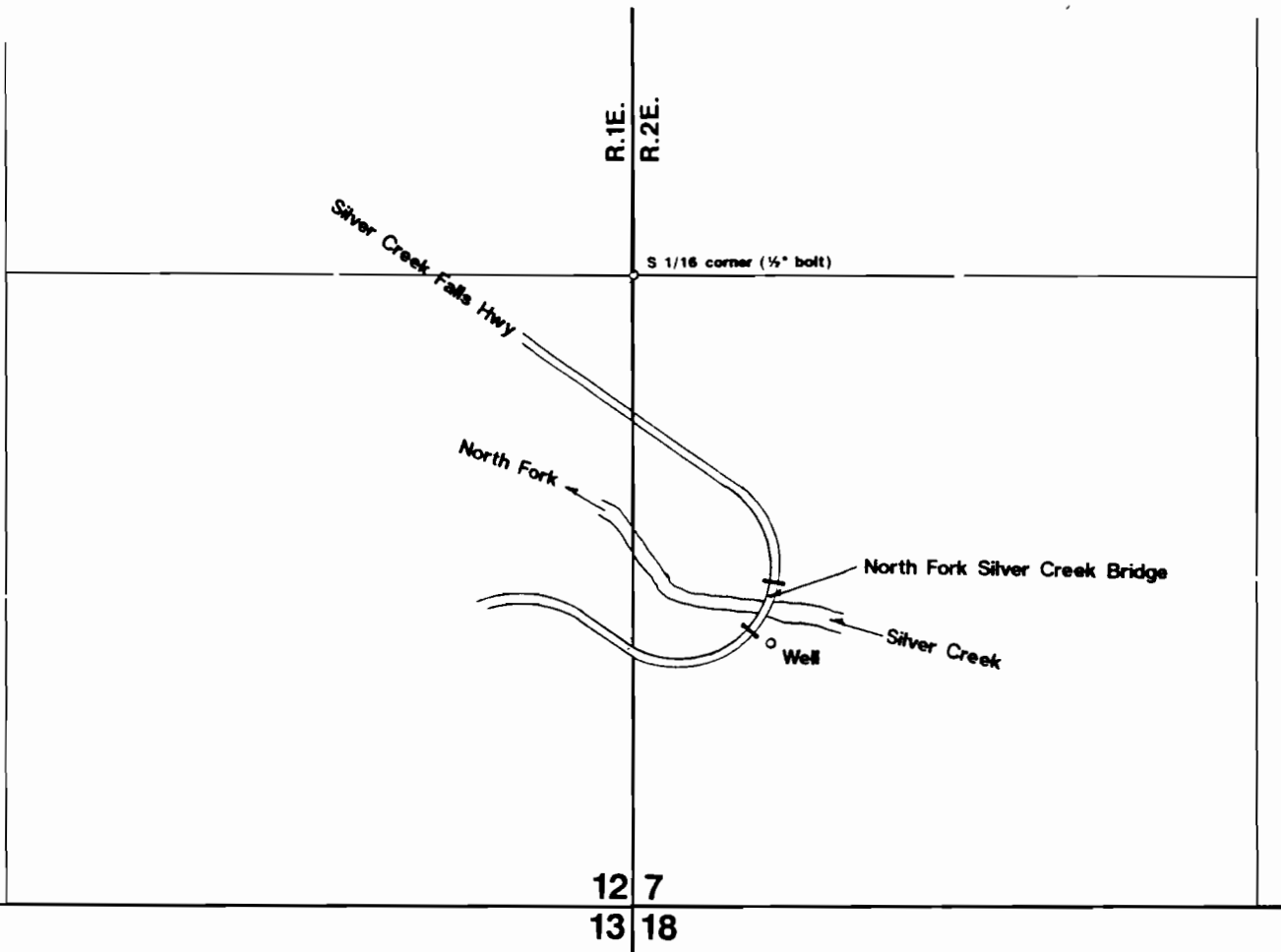

Well is located 775' S & 290' E from the NW corner of SW1/4 SW1/4 of Section 7.

Final Proof Survey

Application #: G-13598 Permit #: G-11887

In Name Of

Oregon Department of Transportation Bridge Section

Surveyed on June 17, 1999 by JM Schuette

This Map Was Prepared For The Purpose Of Identifying The Location Of A Water Right Only And Is Not Intended To Provide Legal Dimensions Or Location Of Property Ownership Lines.

