

RECEIVED

APR 4 1991

WATER RESOURCES DEPT.  
SALEM, OREGON

T.5S., R.2W., W.M.

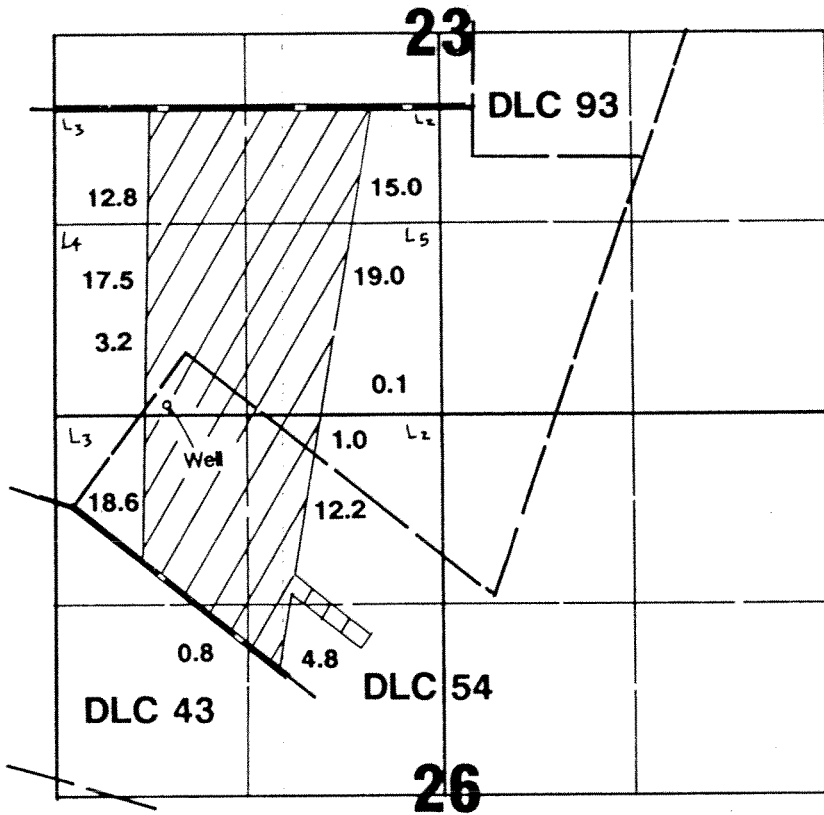

Well located 80'N & 1900'W from NE corner Section 26.

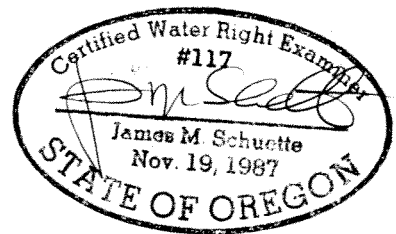
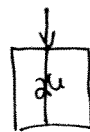

**Paul Jensen**

**Application Map**

Application #: G-12472      Permit #:

THIS MAP WAS PREPARED FOR THE PURPOSE OF IDENTIFYING THE LOCATION OF A WATER RIGHT ONLY AND IS NOT INTENDED TO PROVIDE LEGAL DIMENSIONS OR LOCATION OF PROPERTY OWNERSHIP LINES.

# T.5S. R.2W., W.M

RECEIVED

SEP 29 1998

WATER RESOURCES DEPT  
SALEM, OREGON

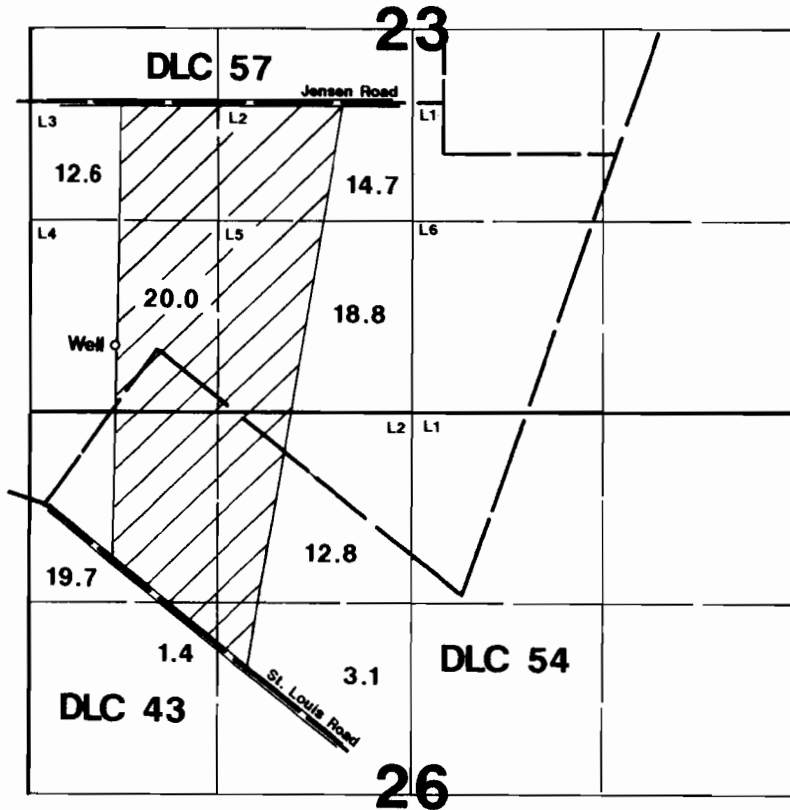

Well is located 430'N & 610'E from the SW corner of Section 23.

## Final Proof Survey

Application #: G-12472    Permit #: G-11892

In Name Of

# Paul Jensen-JB Sod & Seed

Surveyed on September 22, 1998 by JM Schuette

This Map Was Prepared For The Purpose Of Identifying The Location Of A Water Right Only And Is Not Intended To Provide Legal Dimensions Or Location Of Property Ownership Lines.

