

# T.4S., R.1W., W.M.

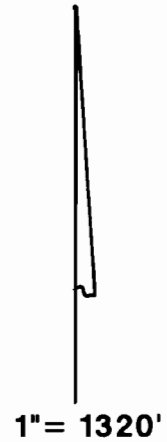
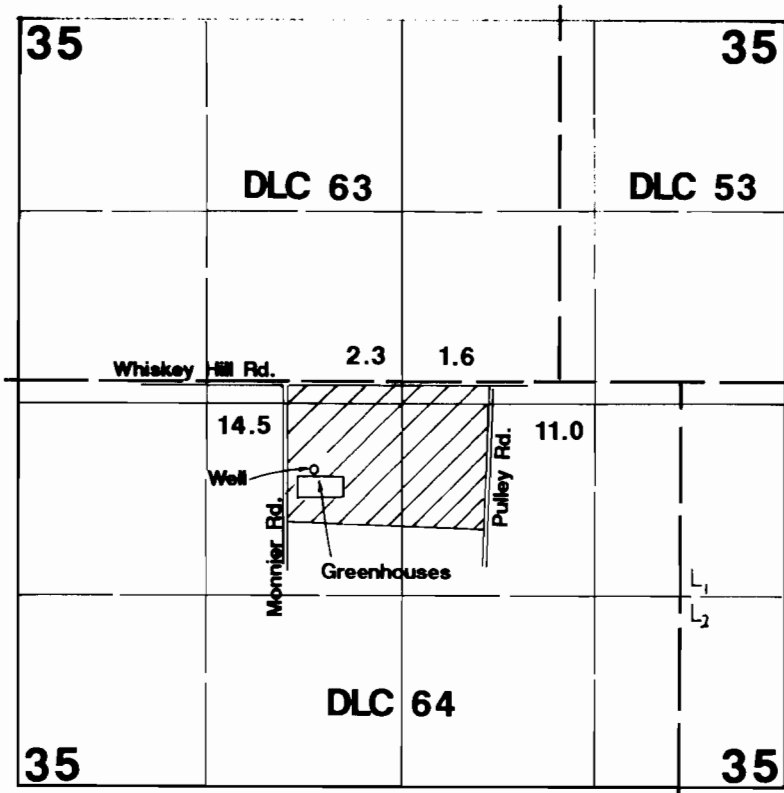

Well located 615'S & 2490'W from NE corner DLC 64.

## Final Proof Survey

Application #: G-12729      Permit #: G-11898      **RECEIVED**

In Name Of

OCT 18 1996

## Dieringer Nursery

WATER RESOURCES DEPT  
SALEM, OREGON

Surveyed on September 28, 1996 by JM Schuette

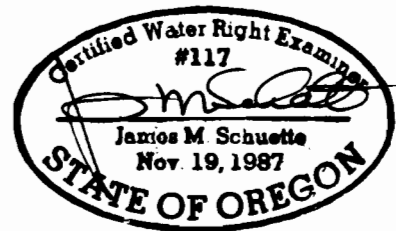

THIS MAP WAS PREPARED FOR THE PURPOSE OF IDENTIFYING THE LOCATION OF A WATER RIGHT ONLY AND IS NOT INTENDED TO PROVIDE LEGAL DIMENSIONS OR LOCATION OF PROPERTY OWNERSHIP LINES.