

# T15S, R4W, W. M.

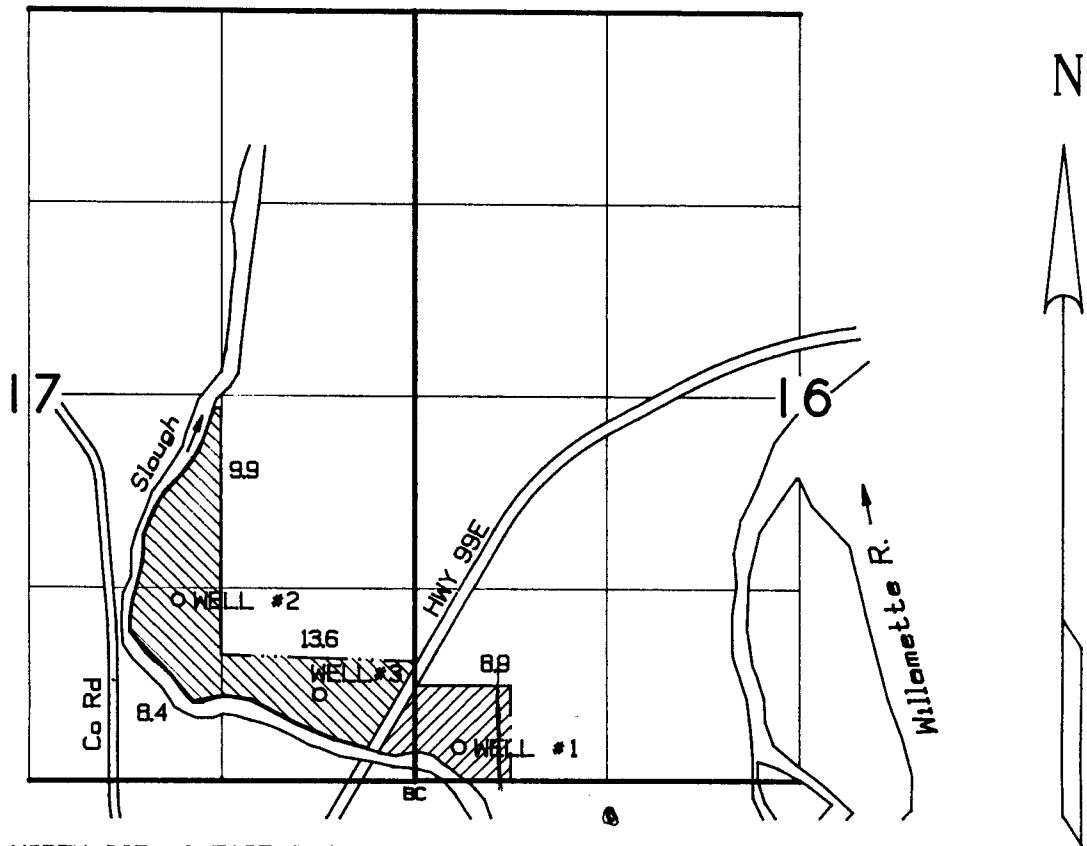

- WELL #1. NORTH 235' & EAST 310' FROM SE COR SEC 17.
- WELL #2. NORTH 1240' & WEST 1615' FROM SE COR SEC 17.
- WELL #3. NORTH 595' & WEST 648' FROM SE COR SEC 17.

1" = 1320'

## Application Map for Ground Water

IN THE NAME OF

NORMAN BURGESS, JOHN BURGESS, & JANET RUSH

Prepared May 14, 1993  
by PARSONS SURVEYING  
1915 S.E. Stone St.  
Corvallis, OR 97333  
(503) 752-7515  
Project No. 9314A

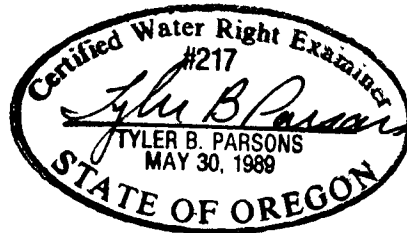

This map is for location of Water Right Application only and does not constitute a boundary survey.

Application No. G-13432  
Permit No. G-11916