

T.3 & 4S., R.1E., W.M.

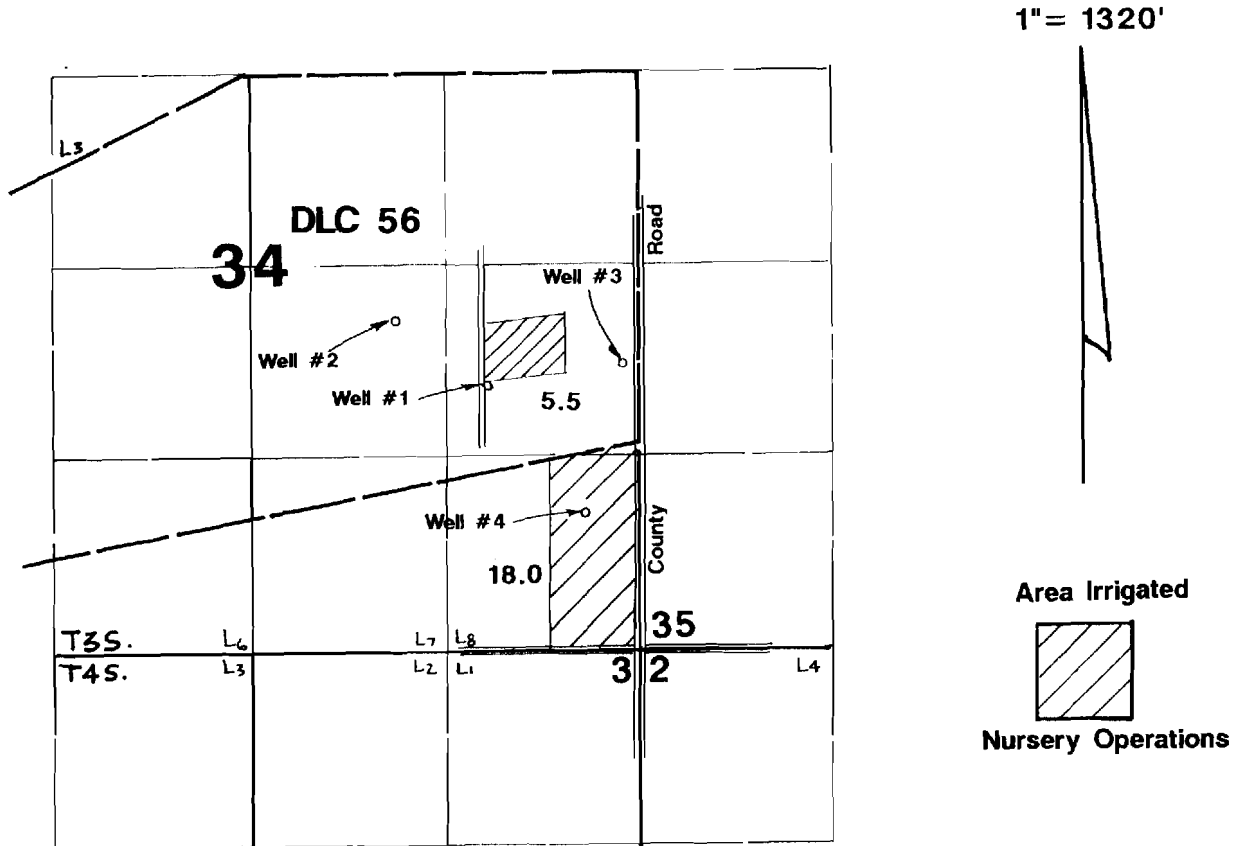

Well #1 located 400'N & 1040'W
 Well #2 located 840'N & 1650'W
 Well #3 located 540'N & 100'W
 Well #4 located 500'S & 350'E all from SE corner DLC 56.

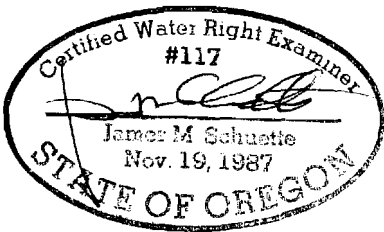

Application Map

Jacque E. Parsons

Application #: *G13466* Permit #: **G11918**

THIS MAP WAS PREPARED FOR THE PURPOSE OF IDENTIFYING THE LOCATION OF A WATER RIGHT ONLY AND IS NOT INTENDED TO PROVIDE LEGAL DIMENSIONS OR LOCATION OF PROPERTY OWNERSHIP LINES.