

T.7S., R.2W., W.M.

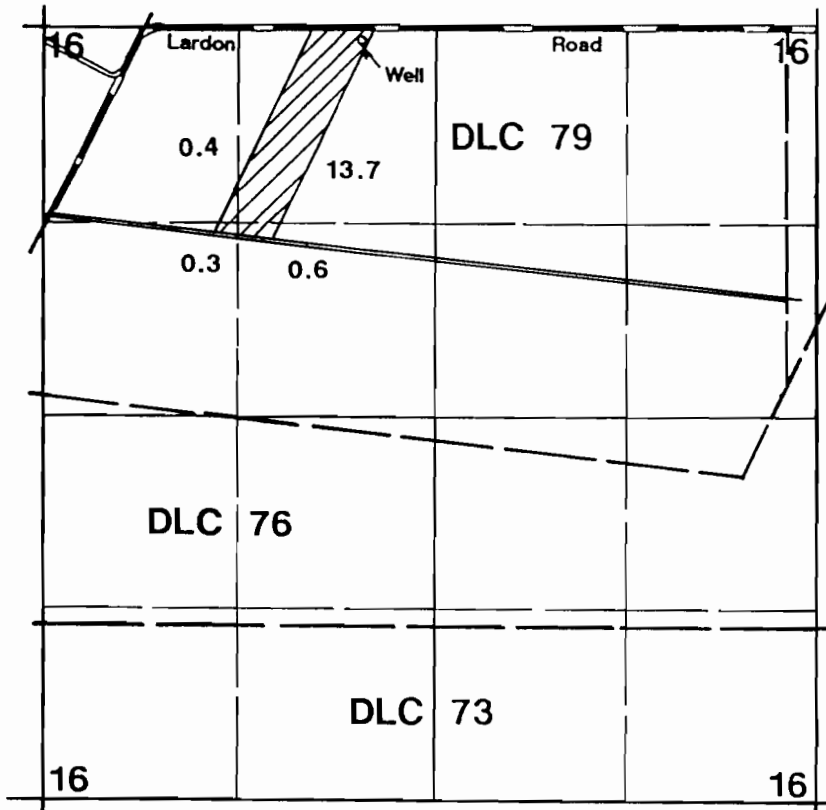

Well located 50'S & 2200'E from NW corner Section 16.

Final Proof Survey

Application #: G-13152 Permit #: G-11980

In Name Of

Robert Simmons

Surveyed on September 9, 1996 by JM Schuette

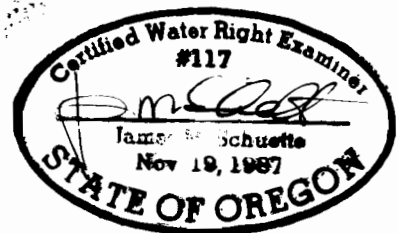

THIS MAP WAS PREPARED FOR THE PURPOSE OF IDENTIFYING THE LOCATION OF A WATER RIGHT ONLY AND IS NOT INTENDED TO PROVIDE LEGAL DIMENSIONS OR LOCATION OF PROPERTY OWNERSHIP LINES.

RECORDED
SEP 11 1996
WATER RIGHTS DIVISION