

FINAL PROOF SURVEY
T.14S. AND T.15S., R.15E. AND R.16E., W.M.
CROOK COUNTY, OREGON

FILE No. G-12344
PERMIT No. G-11993

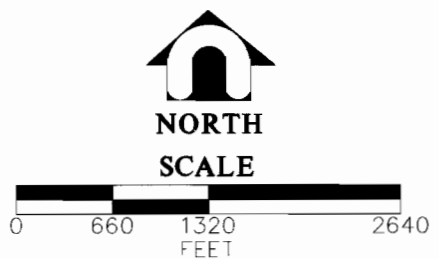

LEGEND:
 - - - URBAN GROWTH BOUNDARY

T.14S.
T.15S.

T.14S.
T.15S.

COBU MAP # 0010

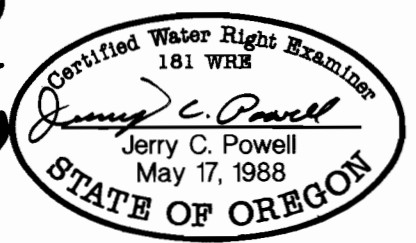

THIS MAP IS FOR THE PURPOSE OF LOCATING A WATER RIGHT AND IS NOT INTENDED TO PROVIDE LEGAL DIMENSIONS FOR PROPERTY BOUNDARIES.

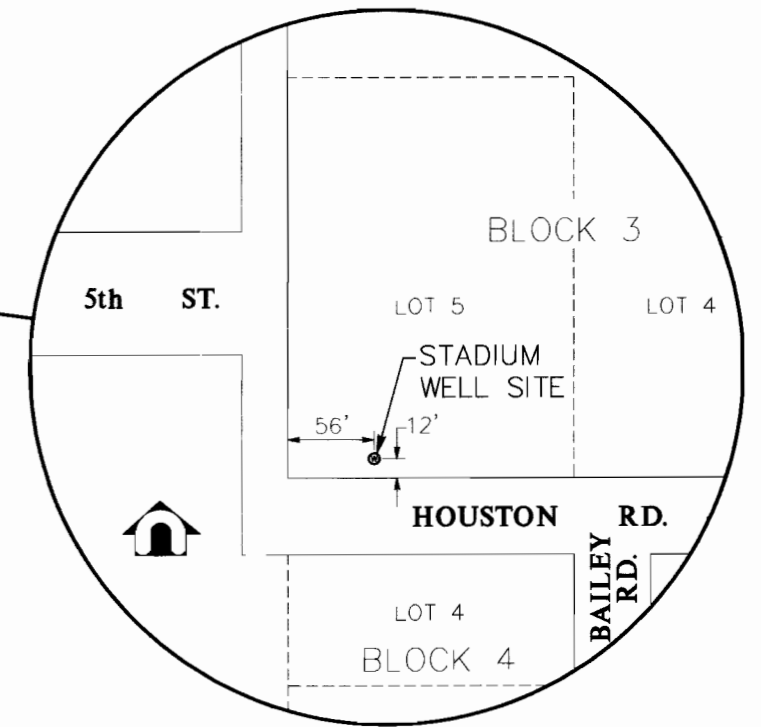

DETAIL
 N.T.S.
 WELL LOCATED NORTH 12 FEET AND EAST A DISTANCE OF 56 FEET FROM THE SOUTHWEST CORNER OF LOT 5 OF BLOCK 3, BAILEY'S SUBDIVISION, CROOK COUNTY, OREGON, OR 21.2 FEET NORTH AND 461 FEET WEST OF THE SOUTHEAST CORNER OF SECTION 5, T.15S., R.16E., W.M.

0010

1	of	1
scale	1" = 1320'	design JCP
date	8/13/97	drawn JHL
file	PRNX0024 - WTRRIGHT.DWG	

	revisions

DAVID EVANS AND ASSOCIATES, INC.
 709 NW Wall Street, Suite 102
 Bend, Oregon 97701 (541) 389-7614



FINAL PROOF SURVEY
CITY OF PRINEVILLE
STADIUM WELL