

T.4S. R.1W., W.M

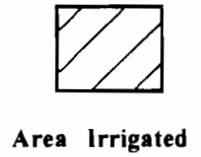
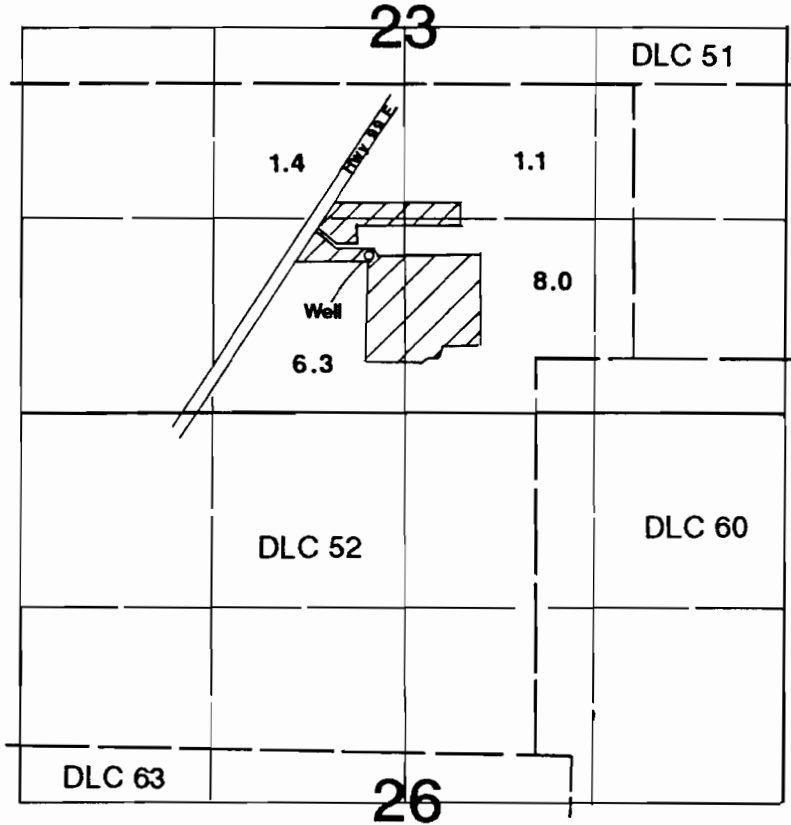
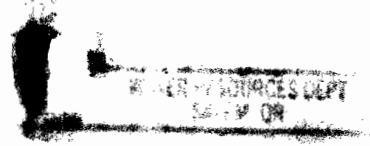

Well is located 1170' S & 1820' W from the NE corner of DLC 52.

Final Proof Survey

Application #: G-12812 Permit #: G-12004

In Name Of

Northwest Hazelnut Company

Surveyed on February 7, 2000 by JM Schuette

This Map Was Prepared For The Purpose Of Identifying The Location Of A Water Right Only And Is Not Intended To Provide Legal Dimensions Or Location Of Property Ownership Lines.

