

RECEIVED

1995

T.2S., R.2&3E., W.M.

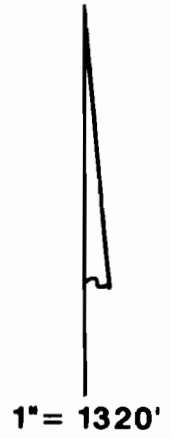
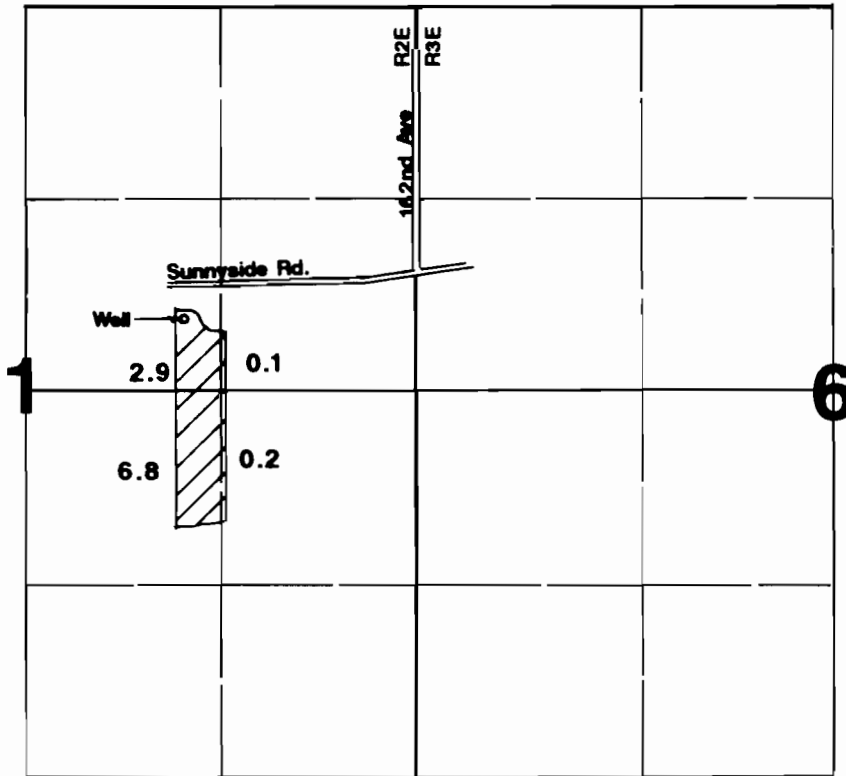

Well located 2160'S & 1570'W from NE corner Section 1.

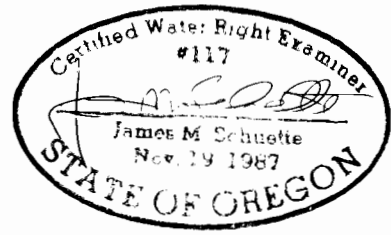

Final Proof Survey

Application #: G-13120 Permit #: G-12012

In Name Of

Fritz Mueller

Surveyed on August 18, 1995 by JM Schuette

THIS MAP WAS PREPARED FOR THE PURPOSE OF IDENTIFYING THE LOCATION OF A WATER RIGHT ONLY AND IS NOT INTENDED TO PROVIDE LEGAL DIMENSIONS OR LOCATION OF PROPERTY OWNERSHIP LINES.