

RECEIVED

T. 24 S., R. 32 1/2 E., W.M.

RECEIVED

FEB 13 1997

HARNEY CO., OREGON

DEC 19 1996

WATER RESOURCES DEPT.  
SALEM, OREGON

WATER RESOURCES DEPT.  
SALEM, OREGON

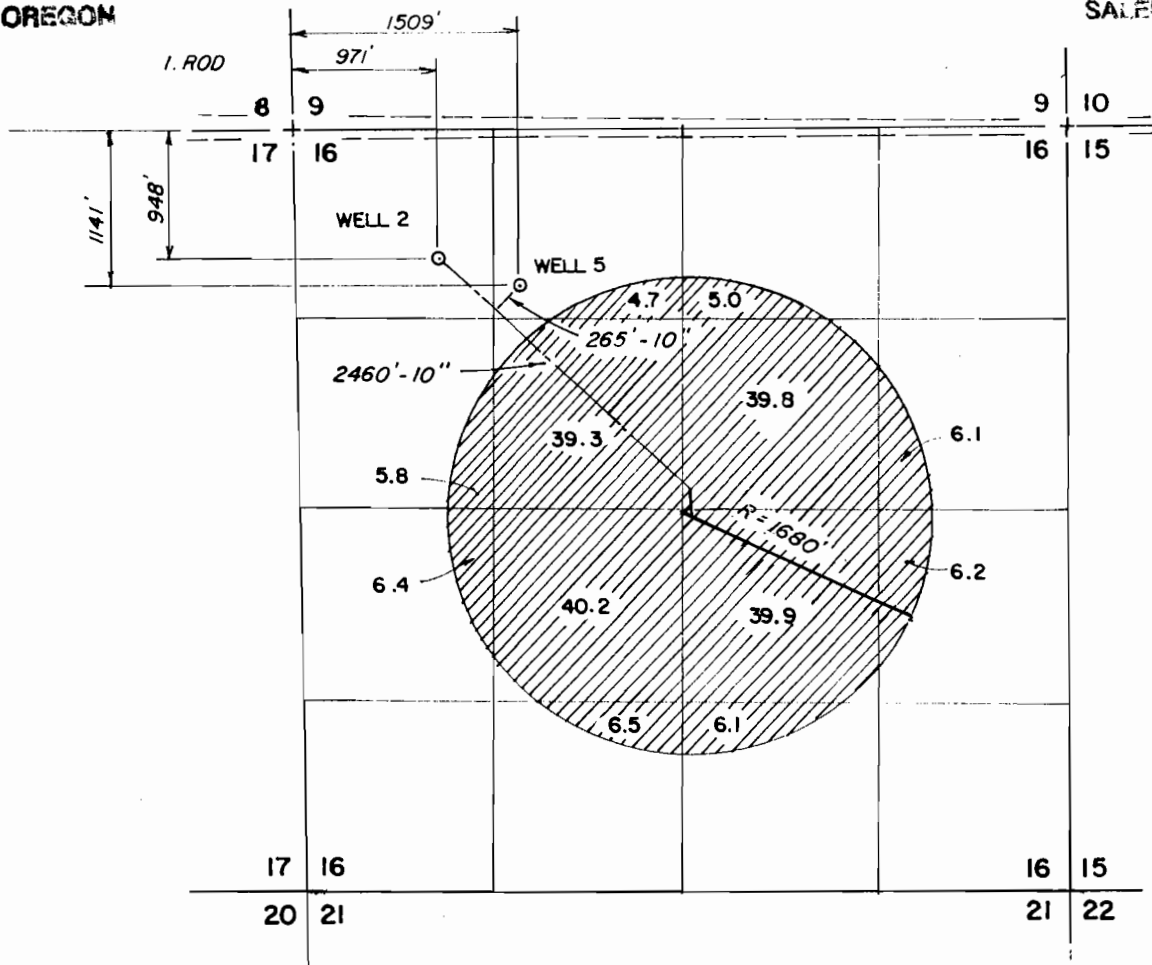

THE PURPOSE OF THIS MAP IS TO IDENTIFY THE LOCATION OF THE WATER RIGHT. IT IS NOT INTENDED TO PROVIDE INFORMATION RELATIVE TO THE LOCATION OF PROPERTY OWNERSHIP

2/3/97 REVISED ACREAGE C.F.P.

MIKE & SHERRI JONES

BURNS, OREGON

# FINAL PROOF MAP

IN THE MATTER OF PERMIT G-12033

Scale: 1" = 1320'

Date: DEC. 4, 1996

Job: 1299

Den: -

Drn: CORK

Ckd: -



M. A. PALMER & SONS, INC.  
ENGINEERING & SURVEYING  
254 N. Alder - Box 61  
Burns, Oregon 97720

Sht. No.

of 1

*Chalif Palmer*  
Professional Engineer  
No. 1111  
State of Oregon

1/1/97 RENEWAL