

RECEIVED

AUG 17 1995

WATER RESOURCES DEPT
SALEM, OREGON

T.6S., R.1W., W.M.

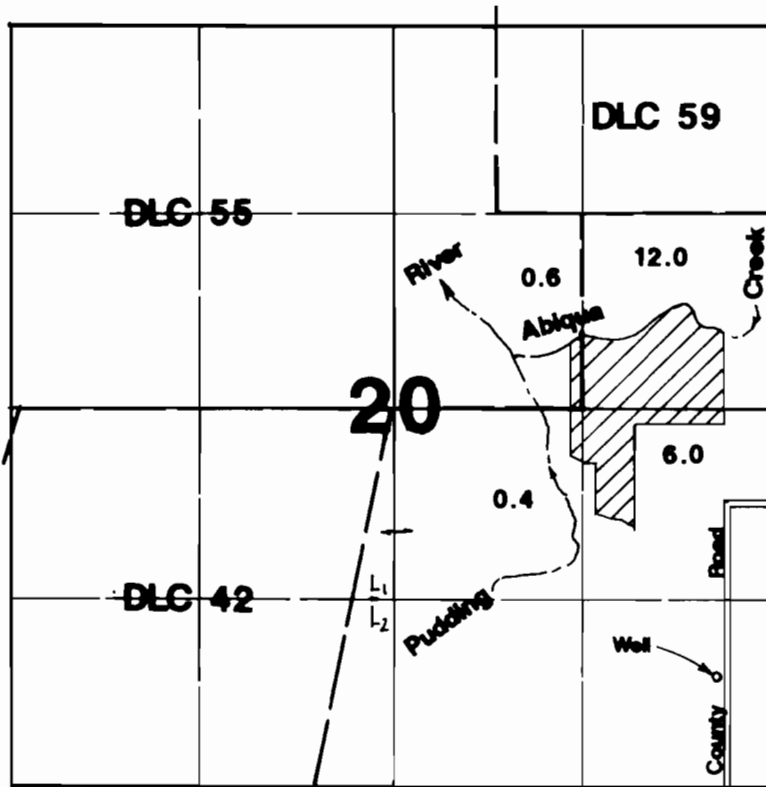

Area Irrigated

Well located 760'N & 350'W from SE corner of Section 20.



Final Proof Survey

Application #: G-12962 Permit #: G-12049

In Name Of

Richard Rawie

Surveyed on August 8, 1995 by JM Schuette

THIS MAP WAS PREPARED FOR THE PURPOSE OF IDENTIFYING THE LOCATION OF A WATER RIGHT ONLY AND IS NOT INTENDED TO PROVIDE LEGAL DIMENSIONS OR LOCATION OF PROPERTY OWNERSHIP LINES.