

T15S, R4W
SECTIONS 31 AND 32
T16S, R4W
SECTIONS 5 AND 6

PERMITS G-12057, G-12121 AND G-12123

1 INCH = 1320 FEET

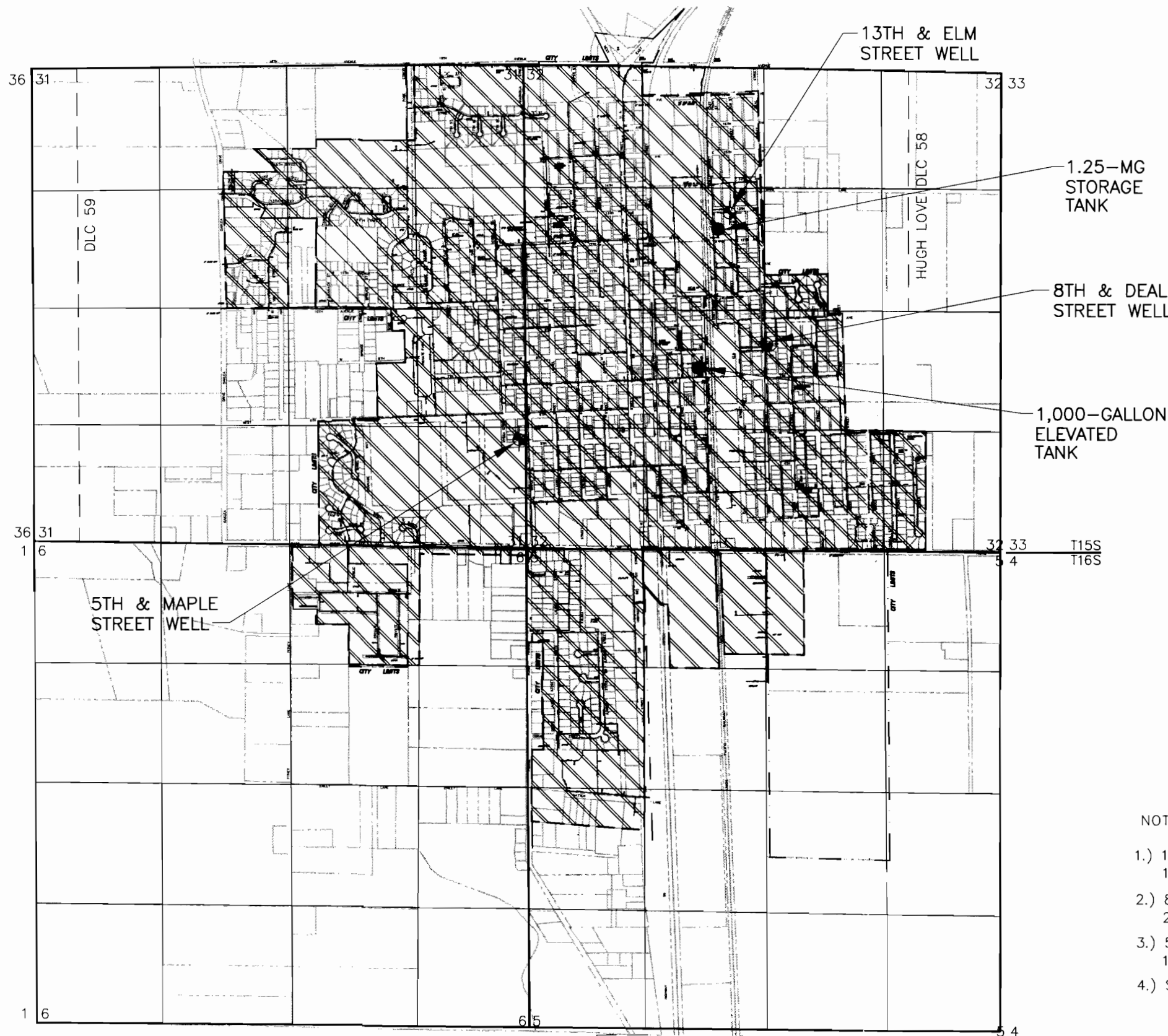

EXPLANATION:

- POINT OF APPROPRIATION
- STORAGE TANK
- PLACE OF USE
- URBAN GROWTH BOUNDARY
- CITY LIMITS

NOTES:

- 1.) 13th & Elm Street well (Permit G-12057, Application G-13206) located 1,640 feet south and 3,050 feet west of NE corner of Section 32.
- 2.) 8th & Deal Street well (Permit G-12121, Application G-12570) located 2,300 feet north and 2,650 feet west of SE corner of Section 32.
- 3.) 5th & Maple Street well (Permit G-12123, Application G-12759) located 1,160 feet north and 100 feet west of SE corner of Section 31.
- 4.) Survey completed on 6/2/04.

References: Junction City Quadrangle (Photorevised 1986) and Tax Lot Maps 150431, 150432, 160406 and 160405.

Portland\p:\11\11340001\00\Cad\COBU_MAP1.dwg SRB:MWJ 08/19/04

THIS MAP IS NOT INTENDED TO PROVIDE LEGAL DIMENSIONS OR LOCATIONS OF PROPERTY OWNERSHIP LINES.



CLAIM OF BENEFICIAL USE MAP
JUNCTION CITY, OREGON

FIGURE 1