

Portland\\P:\11\11340001\00\Cad\COBU_MAP1.dwg SRB:MWJ 08/19/04

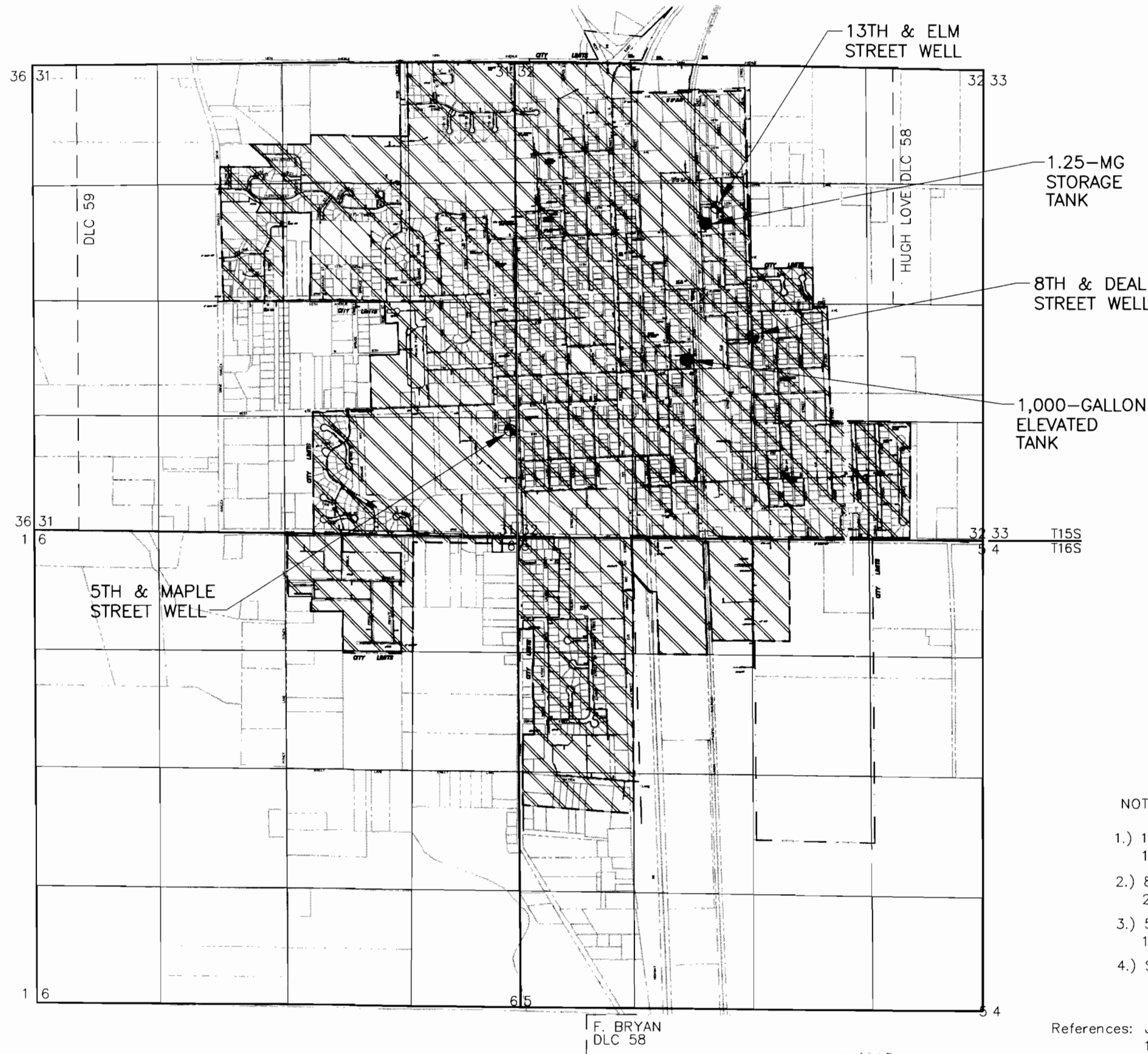

T15S, R4W
SECTIONS 31 AND 32
T16S, R4W
SECTIONS 5 AND 6

PERMITS G-12057, G-12121 AND G-12123

1 INCH = 1320 FEET



EXPLANATION:

- POINT OF APPROPRIATION
- STORAGE TANK
- PLACE OF USE
- URBAN GROWTH BOUNDARY
- CITY LIMITS

NOTES:

- 1.) 13th & Elm Street well (Permit G-12057, Application G-13206) located 1,640 feet south and 3,050 feet west of NE corner of Section 32.
- 2.) 8th & Deal Street well (Permit G-12121, Application G-12570) located 2,300 feet north and 2,650 feet west of SE corner of Section 32.
- 3.) 5th & Maple Street well (Permit G-12123, Application G-12759) located 1,160 feet north and 100 feet west of SE corner of Section 31.
- 4.) Survey completed on 6/2/04.

References: Junction City Quadrangle (Photorevised 1986) and Tax Lot Maps 150431, 150432, 160406 and 160405.

THIS MAP IS NOT INTENDED TO PROVIDE LEGAL DIMENSIONS OR LOCATIONS OF PROPERTY OWNERSHIP LINES.



CLAIM OF BENEFICIAL USE MAP
JUNCTION CITY, OREGON

FIGURE 1