

FINAL PROOF SURVEY AND CLAIM OF BENEFICIAL USE

RECEIVED
5721 1997
WATER RIGHTS DIVISION
94 741 0100

LOCATED IN

NE1/4, NW1/4 and SE1/4, NW1/4, SECTION 10

T3N, R34E, W. M.

UMATILLA COUNTY, OREGON

APPLICATION G-12761

PERMIT G-12171

SHELDON LIEUALLEN

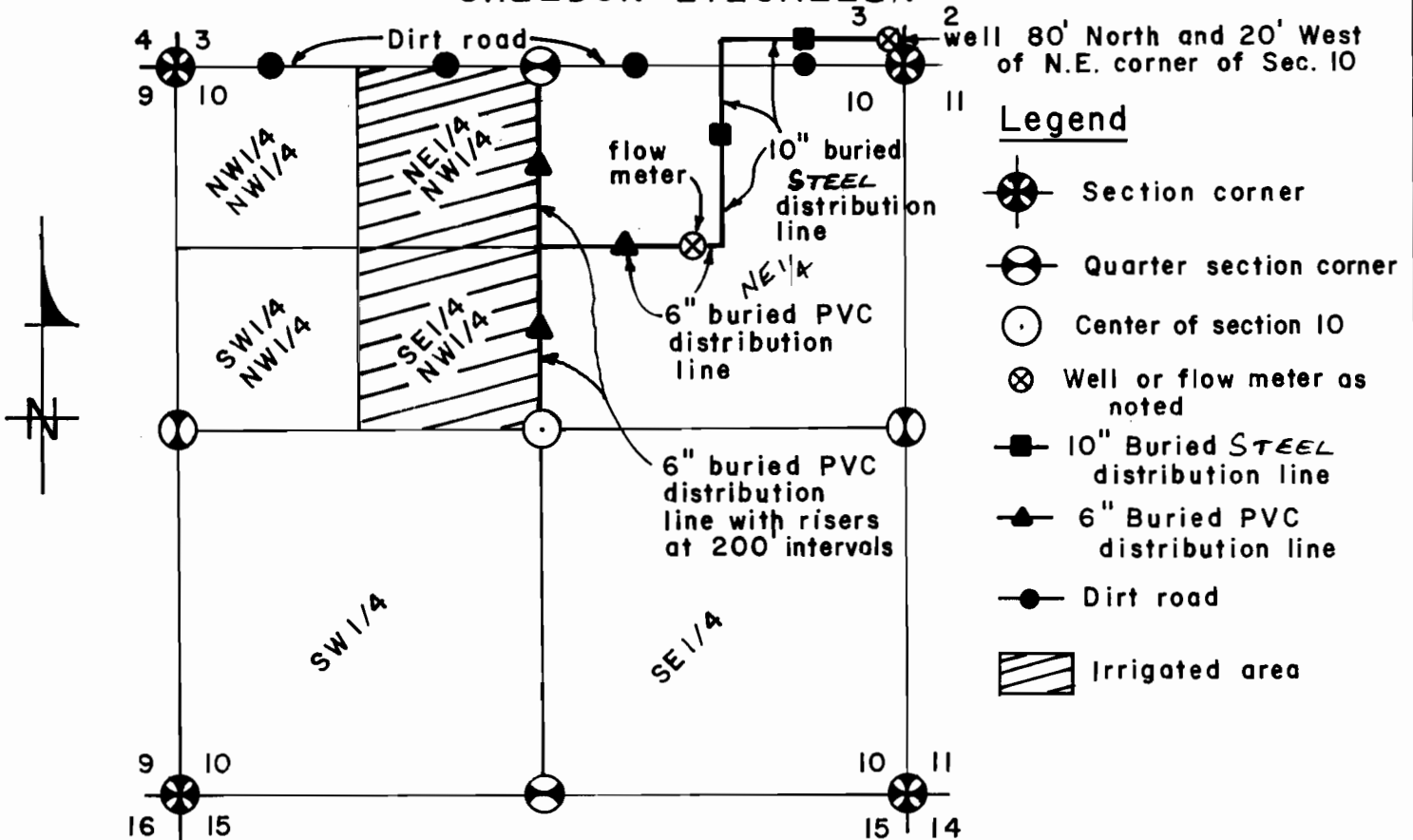

Area beneficially irrigated

NE1/4, NW1/4, Sec. 10: 39.4 Ac.
SE1/4, NW1/4, Sec. 10: 40.0 Ac.
TOTAL : 79.4 Ac.

0 660' 1320'
Scale: 1" = 1320'

This map is prepared for the express purpose to show water appropriation and use. It is not intended to show or locate property ownership lines.

Dennis L. Gaylord
 Nov. 10, 1997
 STATE OF OREGON
 © Renewed 6/30/99

Dennis L. Gaylord, CWRE
4107 S.W. Lake Drive
Pendleton, OR 97801
1 (541) 276-6260
Drawn: D. Messer 9-8-97