

# T.6S., R.2W., W.M.

RECEIVED

AUG 20 1997

WATER RESOURCES DEPT  
SALEM, OREGON

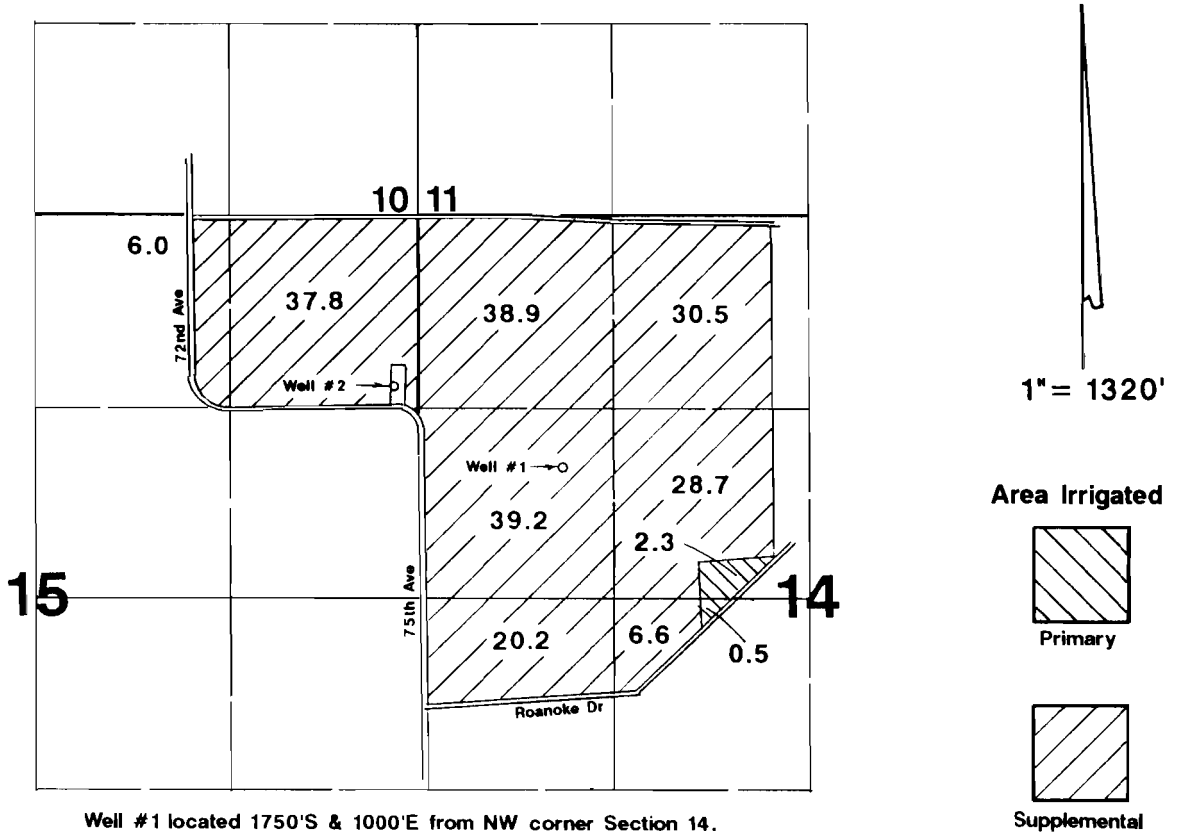

Well #1 located 1750'S & 1000'E from NW corner Section 14.  
Well #2 located 1140'S & 150'W from NW corner Section 14.

## Final Proof Survey

Application #: G-12606      Permit #: G-12181

In Name Of

# James and/or Betty Hollin

Surveyed on July 25, 1997 by JM Schuette

THIS MAP WAS PREPARED FOR THE PURPOSE OF IDENTIFYING THE LOCATION OF A WATER RIGHT ONLY AND IS NOT INTENDED TO PROVIDE LEGAL DIMENSIONS OR LOCATION OF PROPERTY OWNERSHIP LINES.

