

THIS MAP WAS PREPARED FOR THE PURPOSE OF IDENTIFYING THE LOCATION OF THE WATER RIGHT AND IS NOT INTENDED TO PROVIDE LEGAL DIMENSIONS OR LOCATIONS OF PROPERTY OWNERSHIP LINES.

T33S R14W

RECEIVED
JAN 18 1996
WATER RESOURCES DIVISION
SALEM, OREGON

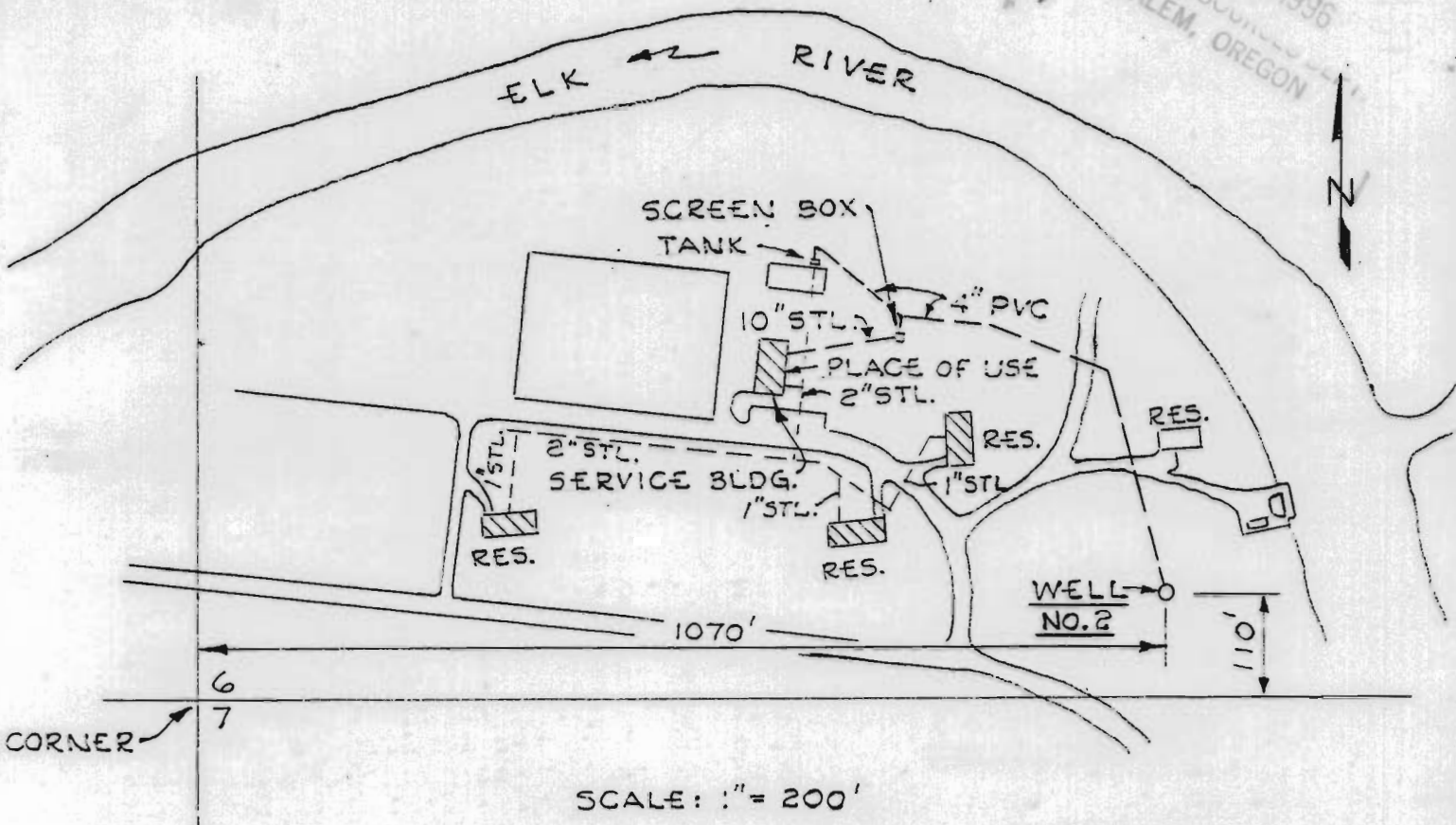

Certified Water Right Examiner
#040
Robert O. Dodge
ROBERT O. DODGE
NOV. 19. 1987
STATE OF OREGON

**FINAL PROOF SURVEY
UNDER**

APPLICATION NO. G-13288 PERMIT NO. G-12205
IN NAME OF

OREGON DEPARTMENT OF FISH AND WILDLIFE

SURVEYED: 1/4/96 BY: DODGE