

T.6S. R.1W., W.M

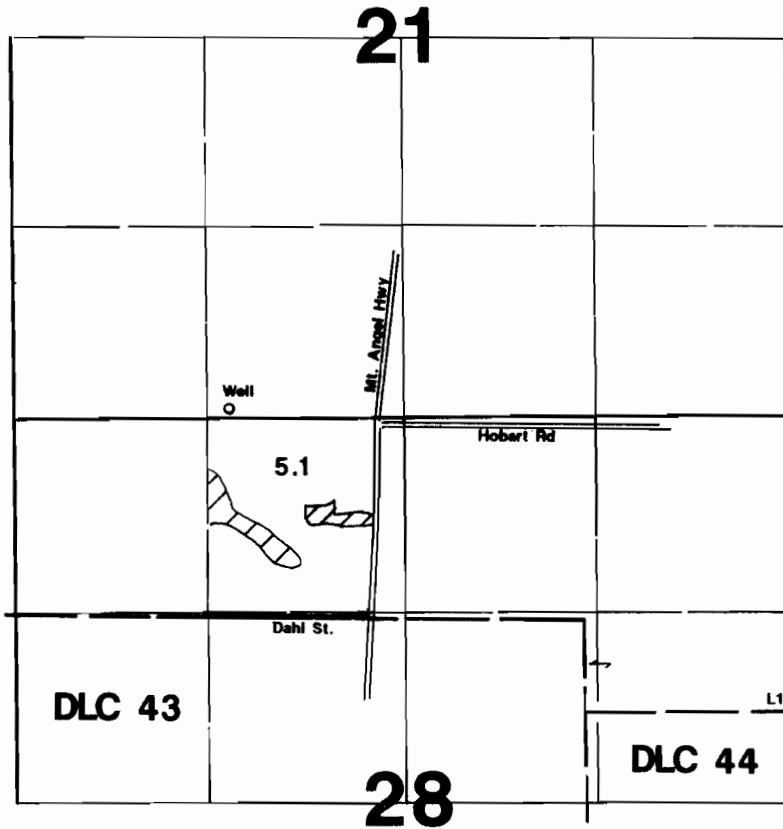

Well located 63°N & 1470°E from the SW corner of Section 21.

1" = 1320'



Area Irrigated

RECEIVED

FEB 15 1999

**WATER RESOURCES DEPT
SALEM, OREGON**

Final Proof Survey

Application #: G-12503 Permit #: G-12208

In Name Of

James Butsch

Surveyed on January 25, 1999 by JM Schuette

This Map Was Prepared For The Purpose Of Identifying The Location Of A Water Right Only And Is Not Intended To Provide Legal Dimensions Or Location Of Property Ownership Lines.

