

# Final Proof Survey

WALTER F. MILLER  
SURVEYOR

Application No. G-14006  
Permit No. G-12256

JIM'S WELL

T.38 S., R.15 E., W.M.  
Klamath County, Oregon  
Fremont National Forest

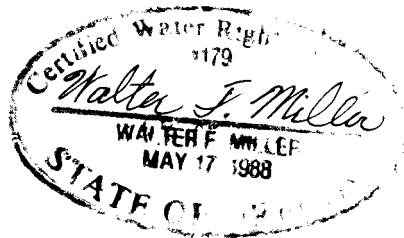

This map was prepared for the purpose of identifying the location of a water right only and is not intended to provide legal dimensions or the location of property ownership lines.

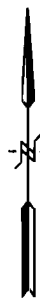
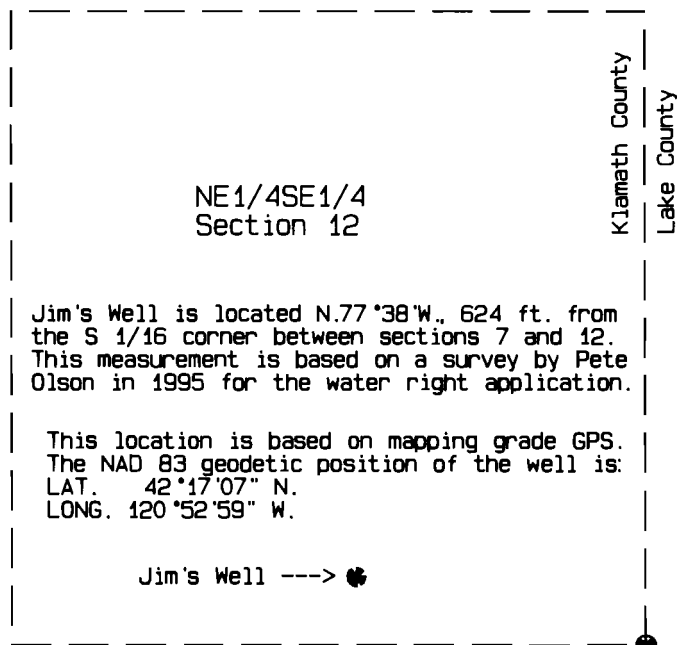

This location is based on mapping grade GPS. The NAD 83 geodetic position of the corner is:  
LAT. 42°17'05" N.  
LONG. 120°52'50" W.

2 1/2" dia. Aluminum Capped Aluminum Pipe per Lake County Surveyors Office marked:

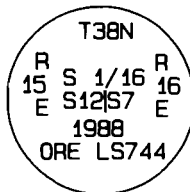

GRAPHIC SCALE 1" = 400'

