

# T.8S. R.4W., W.M

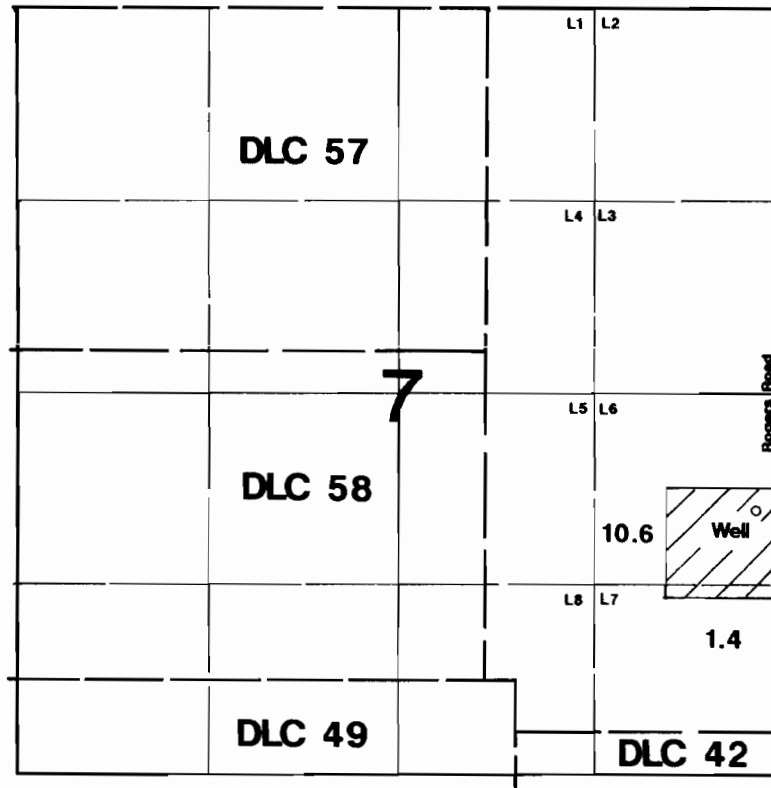

Well is located 760'S & 200'W from the E 1/4 corner of Section 7.

## Final Proof Survey

Application #: G-13534    Permit #: G-12273

In Name Of

**James R. Thompson**

Surveyed on January 27, 2000 by JM Schuette

This Map Was Prepared For The Purpose Of Identifying The Location Of A Water Right Only And Is Not Intended To Provide Legal Dimensions Or Location Of Property Ownership Lines.

